



UTENZILIJA

Proizvodnja lanaca i transportera d.d.

PROJEKTIRA, KONSTRUIRA I PROIZVODI:

- sve tipove lanaca (valjčaste, čahuraste, svornjačne, pločaste, itd.), kao i lance po posebnim zahtjevima kupaca.
- kompletne transportne linije u prehrambenoj industriji (punionice alkoholnih i bezalkoholnih pića, ulja, prerade voća i povrća, prerade mesa, ribe, itd.)
- uređaje za unutarnji transport i prateću opremu uz transportere.
- alate i naprave za proces proizvodnje.

OBAVLJA:

- mehaničku i površinsku obradu metala
- toplinsku obradu poluproizvoda i gotovih proizvoda





KATALOG LANACA I TRANSPORTERA

SADRŽAJ

| | |
|--|--------|
| PRORAČUN DULJINE LANACA PO DIN 8195 | 5 |
| VALJČASTI LANCI DIN 8187 - ISO 606 | 6, 7 |
| VALJČASTI LANCI SA DUGIM ČLANCIMA DIN 8181 - ISO 1275 | 8 |
| NOSIVE SPOJNICE ZA VALJČASTE LANCE PO DIN 8187 i 8181..... | 9, 10 |
| LANCI ZA DIZALA I POKRETNE STEPENICE PO TVORNIČKOJ NORMI | 11 |
| VALJČASTI LANCI ZA POLJOPRIVREDNE STROJEVE DIN 8189 - ISO 487..... | 12, 13 |
| VALJČASTI LANCI ZA POLJOPRIVREDNE STROJEVE PO TVORNIČKOJ NORMI | 14, 15 |
| NOSIVE SPOJNICE ZA POLJOPRIVREDNE LANCE | 16 |
| PLOČASTI LANCI LAKE IZVEDBA LL DIN 8152-ISO 4347..... | 17 |
| PRIJENOSNI LANCI SA PUNIM I ŠUPLJIM SVORNJACIMA DIN 8165 | 18, 19 |
| NOSIVE SPOJNICE PRIJENOSNIH LANACA DIN 8165 | 20 |
| TEŽINE PRIJENOSNIH LANACA DIN 8165 | 21 |
| PRIJENOSNI LANCI DIN 8167-ISO 1977..... | 22, 23 |
| NOSIVE SPOJNICE PRIJENOSNIH LANACA DIN 8167..... | 24 |
| TEŽINE PRIJENOSNIH LANACA DIN 8167..... | 25 |
| DVOSTRANE IZVEDBE (2) PRIJENOSNIH LANACA | 26 |
| POSEBNE IZVEDBE PRIJENOSNIH LANACA | 27 |
| LANCI SA ŠUPLJIM SVORNJACIMA PO TVORNIČKOJ NORMI | 28, 29 |
| LANCI GRABULJARA / REDLERA | 30, 31 |
| LANCI ELEVATORA WN 4141..... | 32 |
| LANCI STROJEVA ZA ASFALT (FINIŠERA) | 33 |
| LANCI ROVOKOPAČA | 34, 35 |
| LANCI GUSJENICA ROVOKOPAČA | 36 |
| ŠARNIRANA LANČANA TRAKA DIN 8153-ISO 4348 | 37, 38 |
| GALLOVI LANCI DIN 8150 | 39 |
| LANCI ZA VUČNE KLUPE BEZ TULJAKA DIN 8156 | 40 |
| BILJEŠKE | 41 |



Pogon sa dva lančanika:

Ako su poznate dimenzije lanaca i približni osni razmak, iz koraka lanca i broja zubi lančanika može se znati broj zglobova lanaca.

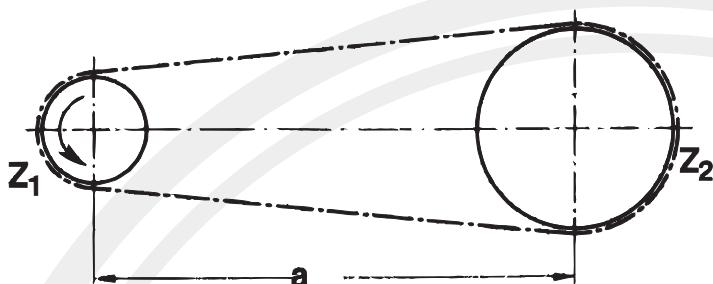

Lančanici sa istim brojem zubi:

$$Z = Z_1 = Z_2$$

$$X_0 = 2 \frac{a_0}{p} + Z$$

Lančanici sa različitim brojem zubi:

$$X_0 = 2 \frac{a_0}{p} + \frac{Z_1 + Z_2}{2} + \frac{f_3 \times p}{a_0}$$

X_0 - broj članaka lanca, a_0 - približni osni razmak; Z_1 Z_2 - brojevi zubi; p - korak lanca;

$$f_3 = \left(\frac{Z_2 - Z_1}{2\pi} \right)^2$$

Tabela: faktor f_3 za lančanike sa različitim brojem zubi

| $Z_2 - Z_1$ | f_3 | $Z_2 - Z_1$ | f_3 | $Z_2 - Z_1$ | f_3 | $Z_2 - Z_1$ | f_3 | $Z_2 - Z_1$ | f_3 |
|-------------|--------|-------------|--------|-------------|--------|-------------|---------|-------------|---------|
| 1 | 0,0253 | 21 | 11,171 | 41 | 42,580 | 61 | 94,254 | 81 | 166,191 |
| 2 | 0,1013 | 22 | 12,260 | 42 | 44,683 | 62 | 97,370 | 82 | 170,320 |
| 3 | 0,2280 | 23 | 13,400 | 43 | 46,836 | 63 | 100,536 | 83 | 174,450 |
| 4 | 0,4053 | 24 | 14,590 | 44 | 49,040 | 64 | 103,753 | 84 | 178,730 |
| 5 | 0,6333 | 25 | 15,831 | 45 | 51,294 | 65 | 107,021 | 85 | 183,011 |
| 6 | 0,912 | 26 | 17,123 | 46 | 53,599 | 66 | 110,339 | 86 | 187,342 |
| 7 | 1,241 | 27 | 18,466 | 47 | 55,955 | 67 | 113,708 | 87 | 191,724 |
| 8 | 1,621 | 28 | 19,859 | 48 | 58,361 | 68 | 117,128 | 88 | 196,157 |
| 9 | 2,052 | 29 | 21,303 | 49 | 60,818 | 69 | 120,598 | 89 | 200,640 |
| 10 | 2,533 | 30 | 22,797 | 50 | 63,326 | 70 | 124,119 | 90 | 205,174 |
| 11 | 3,065 | 31 | 24,342 | 51 | 65,884 | 71 | 127,690 | 91 | 209,759 |
| 12 | 3,648 | 32 | 25,938 | 52 | 68,493 | 72 | 131,313 | 92 | 214,395 |
| 13 | 4,281 | 33 | 27,585 | 53 | 71,153 | 73 | 134,986 | 93 | 219,081 |
| 14 | 4,965 | 34 | 29,282 | 54 | 73,863 | 74 | 138,709 | 94 | 233,817 |
| 15 | 5,699 | 35 | 31,030 | 55 | 76,624 | 75 | 142,483 | 95 | 228,605 |
| 16 | 6,485 | 36 | 32,828 | 56 | 79,436 | 76 | 146,308 | 96 | 233,443 |
| 17 | 7,320 | 37 | 34,677 | 57 | 82,298 | 77 | 150,184 | 97 | 238,322 |
| 18 | 8,207 | 38 | 36,577 | 58 | 85,211 | 78 | 154,110 | 98 | 243,271 |
| 19 | 9,144 | 39 | 38,527 | 59 | 88,175 | 79 | 158,087 | 99 | 248,261 |
| 20 | 10,132 | 40 | 40,529 | 60 | 91,189 | 80 | 162,115 | 100 | 253,302 |

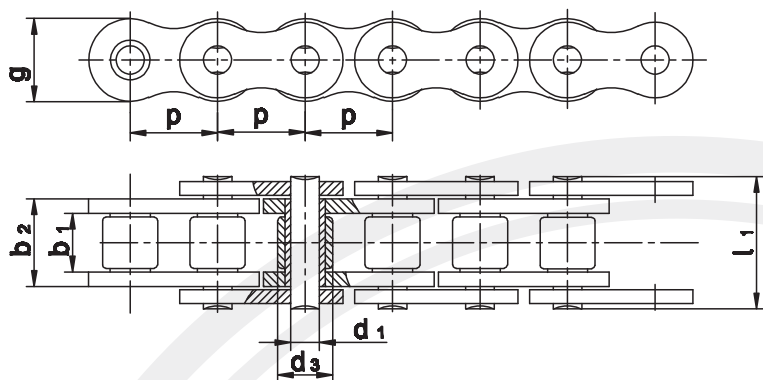

SPOJNI ČLANAK S
OPRUGOM "E"

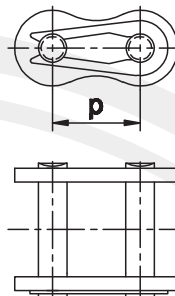

SPOJNI ČLANAK
ZA SKRAĆENJE "L"

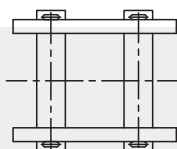
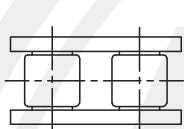
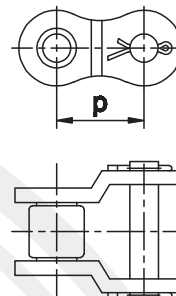

UNUTARNJI ČLANAK "B" VANJSKI ČLANAK "A"

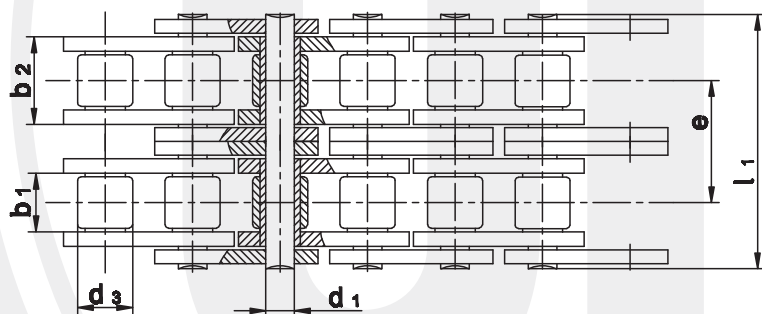

SPOJNI ČLANAK SA
RASCJEPKOM "S"

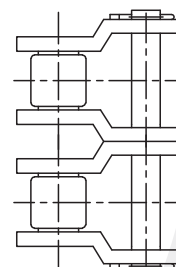
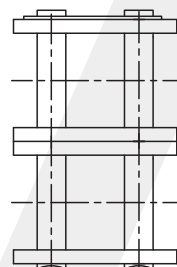

PRIMJERI ZA NARUDŽBU :

1. Narudžba 10 m jednorednog valjčastog lanca koraka 15,875 mm:
10 m VALJČASTOG LANCA
DIN 8187 - 10B - 1
2. Narudžba 5 komada istog lanca od 79 članaka, lanac završava unutarnjim člancima sa obje strane:
5 komada VALJČASTIH LANACA
DIN 8187 - 10B - 1 x 79 B
3. Narudžba 5 komada istog lanca od 100 članaka, lanac ima završni spojni članak sa oprugom:
5 komada VALJČASTIH LANACA
DIN 8187 - 10 B - 1 x 100 E

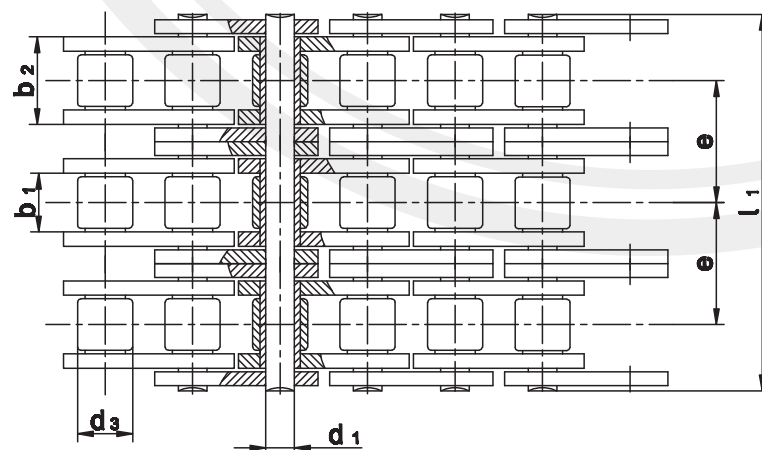



JEDNOREDNI LANCI

| ISO BROJ | p | | b ₁ | d ₃ | d ₁ | b ₂ | l ₁ | g ₁ | e | F _b | q |
|-------------|--------|-------|----------------|----------------|----------------|----------------|----------------|----------------|----|----------------|------|
| | mm | inch | mm | inch | mm | inch | mm | inch | mm | N | Kg/m |
| 06B-1 | 9,525 | 3/8 | 5,72 | 6,35 | 3,28 | 8,53 | 13,5 | 8,26 | | 9000 | 0,41 |
| 081 | 12,7 | 1/2 | 3,3 | 7,75 | 3,66 | 5,8 | 10,2 | 9,91 | | 8200 | 0,28 |
| 083 | 12,7 | 1/2 | 4,88 | 7,75 | 4,09 | 7,9 | 12,9 | 10,3 | | 12000 | 0,42 |
| 084 | 12,7 | 1/2 | 4,88 | 7,75 | 4,09 | 8,8 | 14,8 | 11,15 | | 16000 | 0,59 |
| 08B-1 | 12,7 | 1/2 | 7,75 | 8,51 | 4,45 | 11,3 | 17,0 | 11,81 | | 18000 | 0,70 |
| 10B-1 | 15,875 | 5/8 | 9,65 | 10,16 | 5,08 | 13,28 | 19,6 | 14,73 | | 22400 | 0,95 |
| 12B-1 | 19,05 | 3/4 | 11,68 | 12,07 | 5,72 | 15,62 | 22,7 | 16,13 | | 29000 | 1,25 |
| 16B-1 | 25,4 | 1 | 17,02 | 15,88 | 8,28 | 25,45 | 36,1 | 21,08 | | 60000 | 2,7 |
| 20B-1 | 31,75 | 1 1/4 | 19,56 | 19,05 | 10,19 | 29,01 | 43,2 | 26,42 | | 95000 | 3,6 |
| 24B-1 | 38,1 | 1 1/2 | 25,4 | 25,4 | 14,63 | 37,92 | 53,4 | 33,4 | | 16000 | 6,7 |
| 28B-1 | 44,45 | 1 3/4 | 30,99 | 27,94 | 15,93 | 46,58 | 65,1 | 37,08 | | 200000 | 8,3 |
| 32B-1 | 50,8 | 2 | 30,99 | 29,21 | 17,81 | 45,57 | 67,4 | 42,29 | | 250000 | 10,5 |
| 40B-1 | 63,5 | 2 1/2 | 38,1 | 39,37 | 22,89 | 55,75 | 82,6 | 52,29 | | 355000 | 16,0 |
| 48B-1 | 76,2 | 3 | 45,72 | 48,26 | 29,24 | 70,56 | 99,1 | 63,38 | | 560000 | 25,0 |
| 56B-1 | 88,9 | 3 1/2 | 53,34 | 53,98 | 34,32 | 81,33 | 114,6 | 77,85 | | 850000 | 35,0 |
| 64B-1 | 101,6 | 4 | 60,96 | 63,5 | 39,4 | 92,02 | 131,4 | 90,17 | | 1120300 | 60,0 |
| 72B-1 | 114,3 | 4 1/2 | 68,58 | 72,39 | 44,48 | 103,81 | 148,7 | 103,63 | | 1400000 | 80,0 |

DVOREDNI LANCI

| | | | | | | | | | | | |
|-------|--------|-------|-------|-------|-------|--------|-------|--------|--------|---------|-------|
| 06B-2 | 9,525 | 3/8 | 5,72 | 6,35 | 3,28 | 8,53 | 23,8 | 8,26 | 10,24 | 16000 | 0,78 |
| 08B-2 | 12,7 | 1/2 | 7,75 | 7,75 | 4,45 | 11,3 | 31,0 | 11,81 | 13,92 | 32000 | 1,35 |
| 10B-2 | 15,875 | 5/8 | 9,65 | 10,16 | 5,08 | 13,28 | 36,2 | 14,73 | 16,59 | 40000 | 1,35 |
| 12B-2 | 19,05 | 3/4 | 11,68 | 12,07 | 5,72 | 15,62 | 42,2 | 16,13 | 19,46 | 53000 | 2,5 |
| 16B-2 | 25,4 | 1 | 17,02 | 15,88 | 8,28 | 25,45 | 68 | 21,08 | 31,88 | 106000 | 5,4 |
| 20B-2 | 31,75 | 1 1/4 | 19,56 | 19,05 | 10,19 | 29,01 | 79,7 | 26,42 | 36,45 | 170000 | 7,2 |
| 24B-2 | 38,1 | 1 1/2 | 25,4 | 25,4 | 14,63 | 37,92 | 101,8 | 33,4 | 48,36 | 280000 | 13, |
| 28B-2 | 44,45 | 1 3/4 | 30,99 | 27,94 | 15,93 | 46,58 | 124,7 | 37,08 | 59,56 | 360000 | 16,6 |
| 32B-2 | 50,8 | 2 | 30,99 | 29,21 | 17,81 | 45,57 | 126,0 | 42,29 | 58,55 | 450000 | 21,0 |
| 40B-2 | 63,5 | 2 1/2 | 38,1 | 39,37 | 22,89 | 55,75 | 154,9 | 52,29 | 72,29 | 630000 | 32,0 |
| 48B-2 | 76,2 | 3 | 45,72 | 48,26 | 29,24 | 70,56 | 190,4 | 63,38 | 91,21 | 1000000 | 50,0 |
| 56B-2 | 88,9 | 3 1/2 | 53,34 | 53,98 | 34,32 | 81,33 | 221,2 | 77,85 | 106,6 | 1600000 | 70,0 |
| 64B-2 | 101,6 | 4 | 60,96 | 63,5 | 39,4 | 92,02 | 251,4 | 90,17 | 119,89 | 2000000 | 120,0 |
| 72B-2 | 114,3 | 4 1/2 | 68,58 | 72,39 | 44,48 | 103,81 | 285,1 | 103,63 | 136,27 | 2500000 | 160,0 |

TROREDNI LANCI

| | | | | | | | | | | | |
|-------|--------|-------|-------|-------|-------|--------|-------|--------|--------|---------|-------|
| 06B-3 | 9,525 | 3/8 | 5,72 | 6,35 | 3,28 | 8,53 | 34,0 | 8,26 | 10,24 | 23600 | 1,18 |
| 08B-3 | 12,7 | 1/2 | 7,75 | 8,51 | 4,45 | 11,3 | 44,9 | 11,81 | 13,92 | 47500 | 2,0 |
| 10B-3 | 15,875 | 5/8 | 9,65 | 10,16 | 5,08 | 13,28 | 52,8 | 14,73 | 16,59 | 60000 | 2,8 |
| 12B-3 | 19,05 | 3/4 | 11,68 | 12,07 | 5,72 | 15,62 | 61,7 | 16,13 | 19,46 | 80000 | 3,8 |
| 16B-3 | 25,4 | 1 | 17,02 | 15,88 | 8,28 | 25,45 | 99,9 | 21,08 | 31,88 | 160000 | 8,0 |
| 20B-3 | 31,75 | 1 1/4 | 19,56 | 19,05 | 10,19 | 29,01 | 116,1 | 26,42 | 36,45 | 250000 | 11,0 |
| 24B-3 | 38,1 | 1 1/2 | 25,4 | 25,4 | 14,63 | 37,92 | 150,2 | 33,4 | 48,36 | 425000 | 21,0 |
| 28B-3 | 44,45 | 1 3/4 | 30,99 | 27,94 | 15,93 | 46,58 | 184,3 | 37,08 | 59,56 | 530000 | 25,0 |
| 32B-3 | 50,8 | 2 | 30,99 | 29,21 | 17,81 | 45,57 | 184,5 | 42,29 | 58,55 | 670000 | 32,0 |
| 40B-3 | 63,5 | 2 1/2 | 38,1 | 39,37 | 22,89 | 55,75 | 227,2 | 52,29 | 72,29 | 950000 | 48,0 |
| 48B-3 | 76,2 | 3 | 45,72 | 48,26 | 29,24 | 70,56 | 281,6 | 63,38 | 91,21 | 1500000 | 75,0 |
| 56B-3 | 88,9 | 3 1/2 | 53,34 | 53,98 | 34,32 | 81,33 | 330,0 | 77,85 | 106,6 | 2240000 | 105,0 |
| 64B-3 | 101,6 | 4 | 60,96 | 63,5 | 39,4 | 92,02 | 371,4 | 90,17 | 119,89 | 3000000 | 180,0 |
| 72B-3 | 114,3 | 4 1/2 | 68,58 | 72,39 | 44,48 | 103,81 | 421,6 | 103,63 | 136,27 | 3750000 | 240,0 |

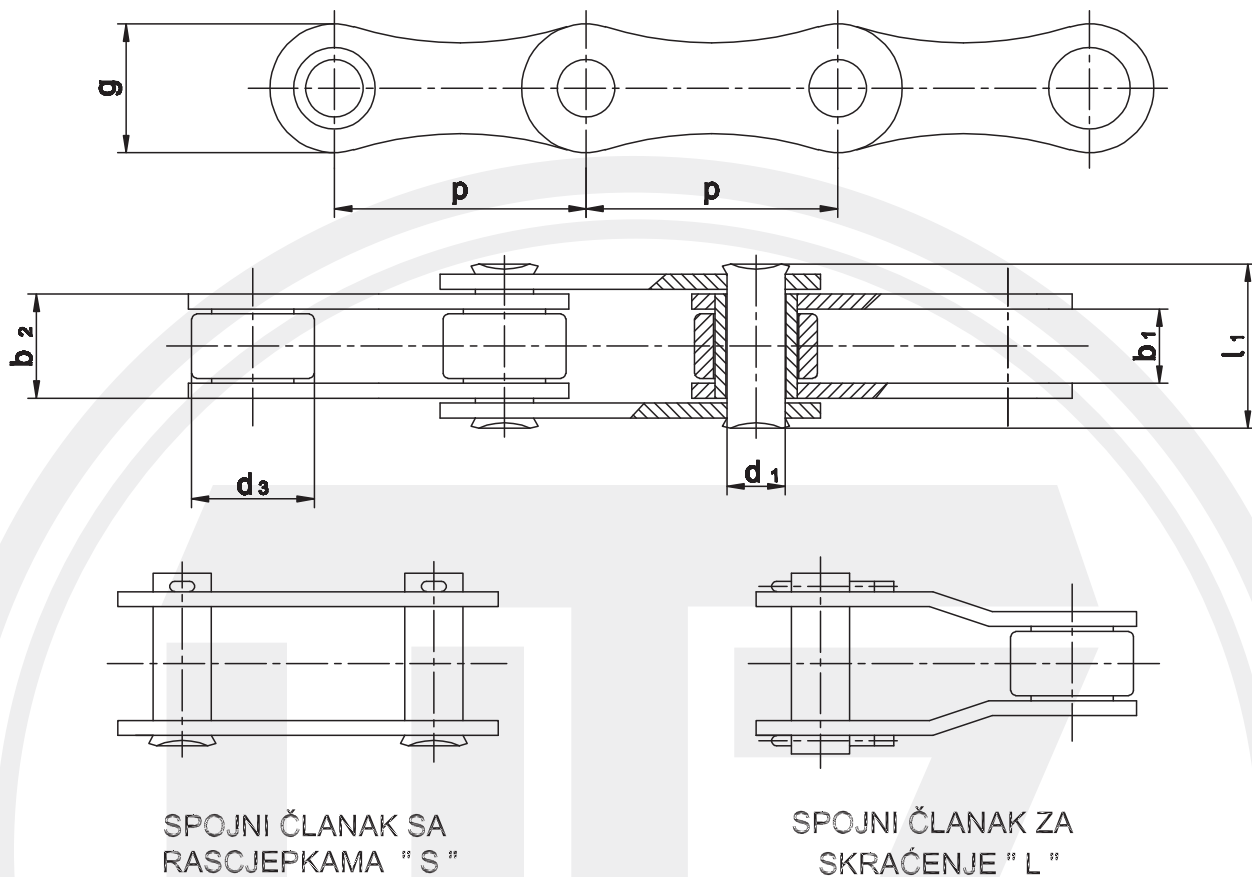

| ISO broj | p mm | b 1 mm | d 3 mm | d 1 mm | b 2 mm | l 1 mm | g mm | Fb N | q kg/m |
|---------------|---------|-----------|-----------|-----------|-----------|-----------|---------|---------|-----------|
| 208 B* | 25,4 | 7,75 | 8,51 | 4,45 | 11,6 | 17 | 11,8 | 18000 | 0,45 |
| 210 B* | 31,75 | 9,65 | 10,16 | 5,08 | 13,28 | 19,6 | 14,7 | 22400 | 0,65 |
| 212 B | 38,1 | 11,68 | 12,07 | 5,72 | 15,62 | 22,7 | 16,1 | 29000 | 0,76 |
| 216 B | 50,8 | 17,02 | 15,88 | 8,28 | 25,4 | 36,1 | 21 | 60000 | 1,75 |
| 220 B | 63,5 | 19,56 | 19,05 | 10,19 | 29 | 43,2 | 26,4 | 95000 | 1,95 |
| 224 B | 76,2 | 25,4 | 25,4 | 14,63 | 37,9 | 53,4 | 33,4 | 160000 | 4,5 |
| 228 B | 88,9 | 30,99 | 27,94 | 15,9 | 46,5 | 65,1 | 37 | 200000 | 6 |
| 232 B | 101,6 | 30,99 | 29,21 | 17,81 | 45,5 | 67,4 | 42,2 | 250000 | 6,5 |

* nisu u proizvodnom programu

PRIMJER ZA NARUDŽBU:

- Narudžba 12,7 m valjčastog lanca sa dugim člancima br. 208 B
12,7 m VALJČASTOG LANCA DIN 8181 - 208 B
- narudžba 5 komada valjčastog lanca od 100 članaka i spojnim člancima sa rascjepkama za isti lanac:
5 KOMADA VALJČASTIH LANACA DIN 8181 - 208 B x 100 S

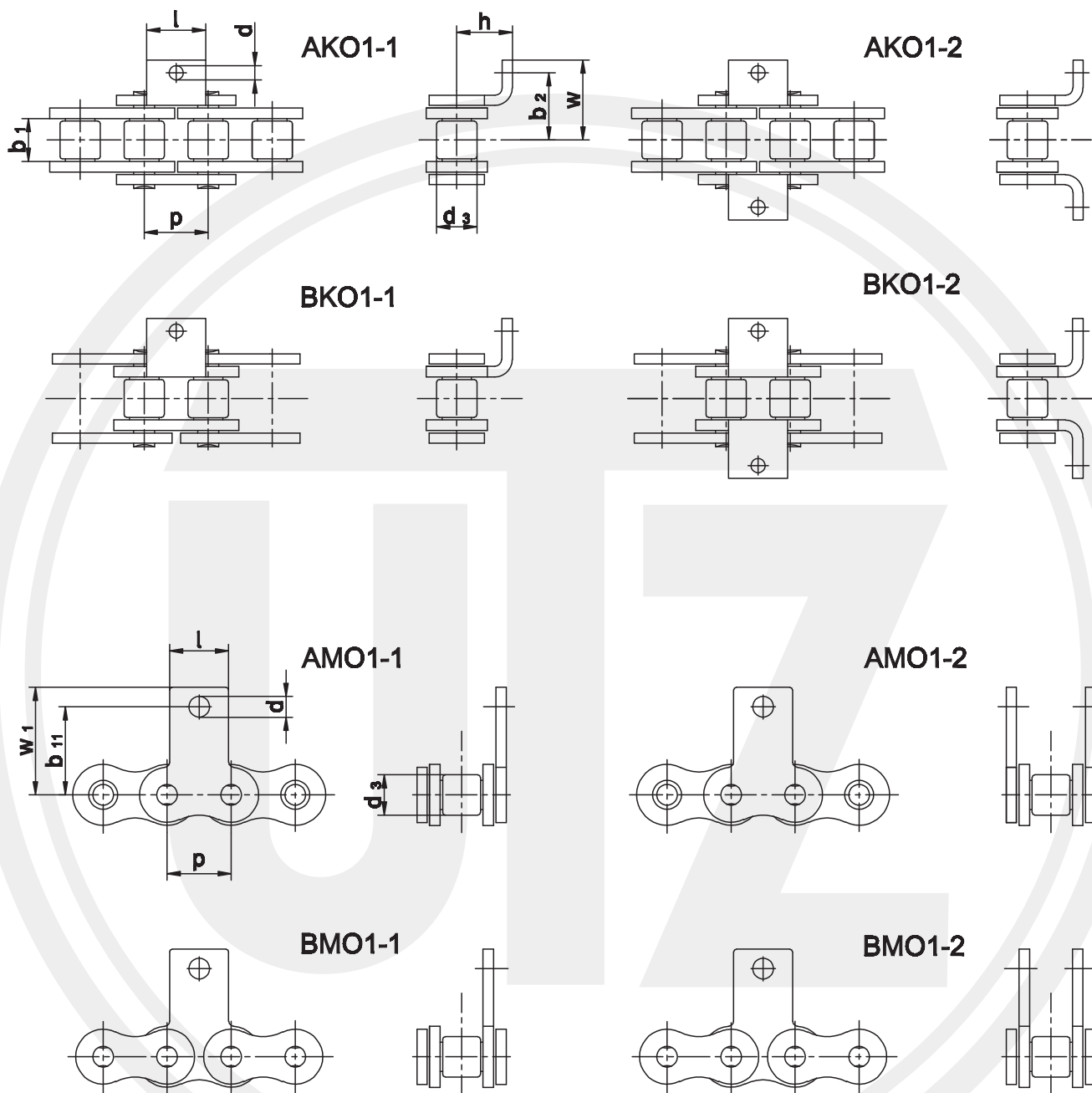

- A** = nosive spojnice na vanjskom članku
B = nosive spojnice na unutarnjem članku
K = savijena nosiva spojnica
M = uspravna nosiva spojnica
O = okrugla rupa jedna, odnosno dvije
-1 = sa jedne strane lanca
-2 = sa obje strane lanca

Mjere na upit.



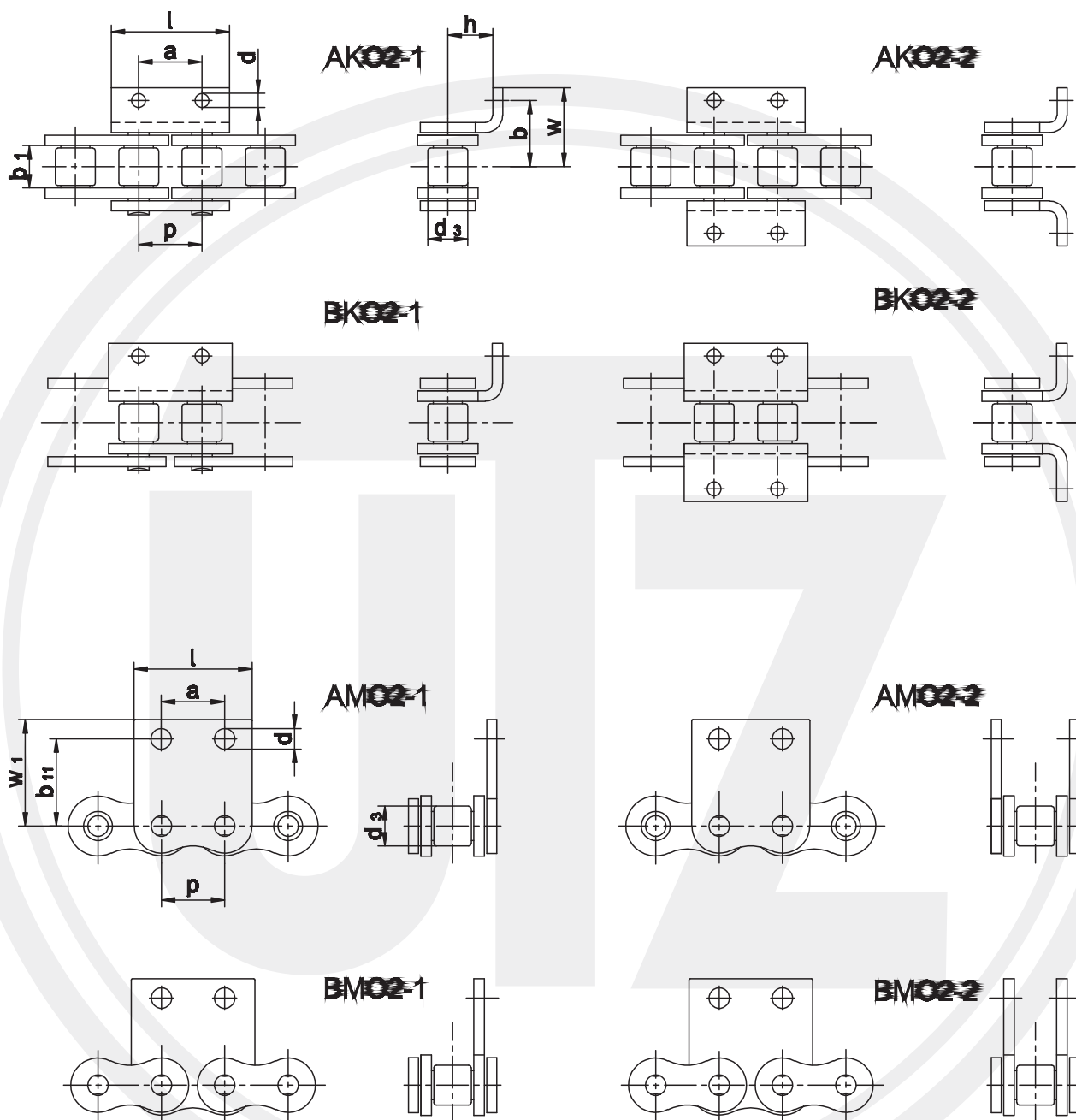

Napomene: udaljenost između nosivih spojnica na koraku lanca
izraziti u mm ili kao "n"-ti članak.

Mjere na upit.



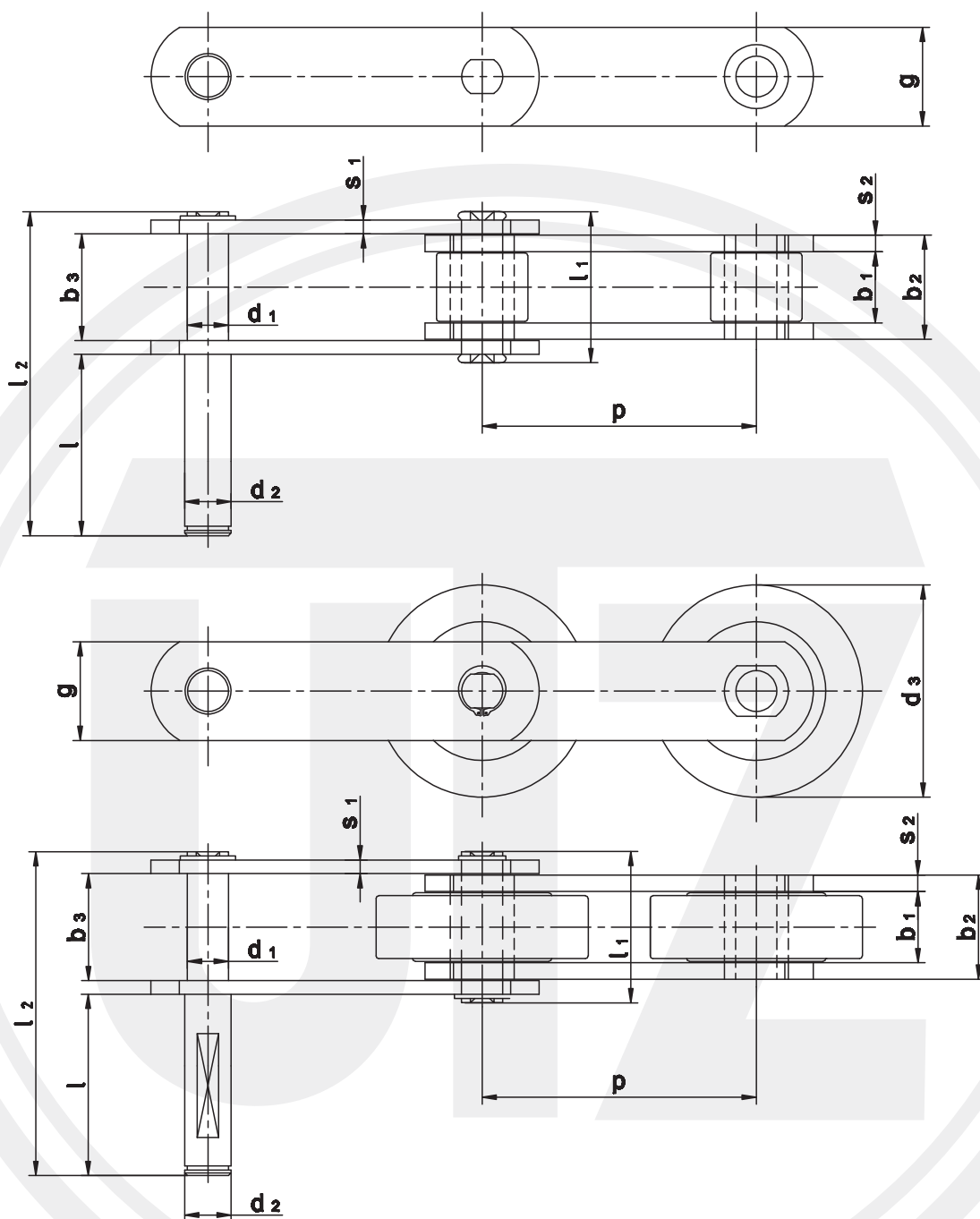

| p | b1 | d3 | d1 | d2 | *1 | b2 | g | s1/s2 | l1 | l2 | *2 | l | *2 | Fb | q |
|--------|-------|-------|-------|----|----|------|--------|-------|------|-------|----|----|----|--------|-----|
| mm | mm | mm | mm | mm | mm | mm | mm | mm | mm | mm | mm | mm | mm | N | mm |
| 50 | 25,4 | 25,4 | 14,63 | | | 37,9 | 40 | 5/6 | 53,4 | | | | | 160000 | 8,7 |
| 80 | 30,99 | 37,94 | 15,9 | | | 45,5 | 40 | 6/7 | 64 | | | | | 200000 | 8,7 |
| 100 | 25,4 | 25,4 | 14,63 | | | 37,9 | 35(40) | 5/6 | 53,4 | | | | | 160000 | 5,3 |
| 101,25 | 25,4 | 25,4 | 14,63 | 15 | | 37,9 | 35 | 5/6 | 53,4 | 146,6 | 93 | | | 160000 | 5,5 |
| 101,25 | 25,4 | 36 | 20 | 15 | | 37,9 | 45 | 6 | 56,2 | 148,8 | 93 | | | 182000 | 9,0 |
| 101,25 | 27,4 | 75 | 14,63 | 15 | | 40,4 | 35 | 6 | 61,8 | 117,2 | 60 | | | 160000 | 8,7 |
| 101,60 | 30,99 | 29,21 | 17,81 | | | 45,5 | 45(50) | 6/7 | 64,8 | | | | | 250000 | 8,6 |

*1, *2 - mjere na upit - po želji kupca



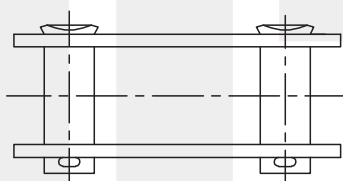
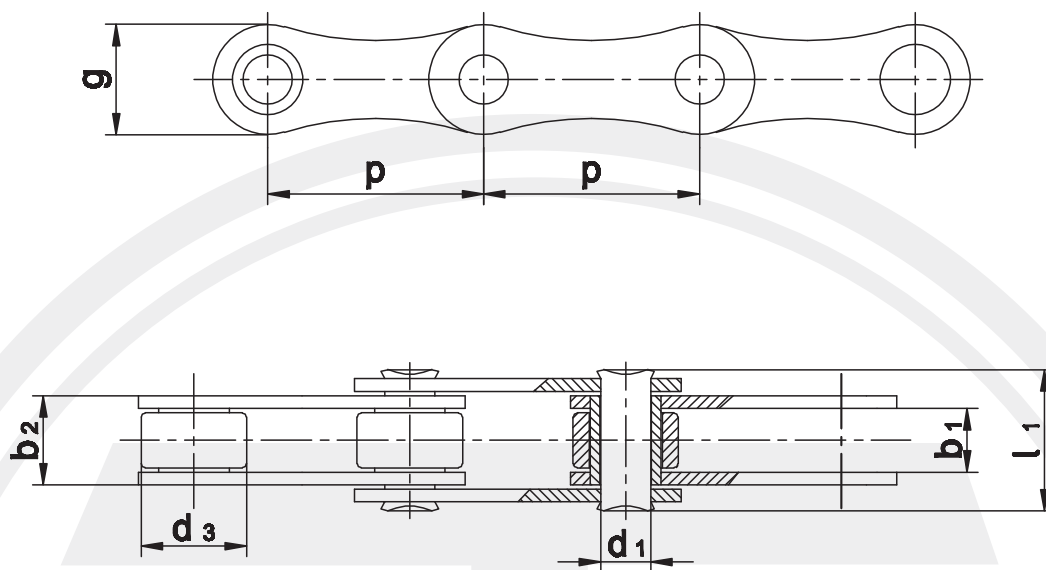

**SPOJNI ČLANAK SA
RASCJEPKAMA "S"**

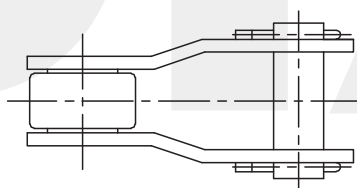

**SPOJNI ČLANAK ZA
SKRAĆENJE "L"**

PRIMJER ZA NARUDŽBU:

1. Narudžba 10 m valjčastog lanca koraka 41,4 mm:
10 m VALJČASTOG LANCA DIN 8189 - S 55
2. Narudžba 5 kom. istog lanca od 79 članaka:
5 kom VALJČASTOG LANCA DIN 8189 S 55 x 79
3. Narudžba 5 kom. istog lanca od 100 članaka, uključujući i spojni članak sa rascjepkama
5 kom VALJČASTOG LANCA DIN 8189 - S 55 x 100 "S"





| ISO broj | p | b ₁ | d ₃ | d ₁ | b ₂ | g | l ₁ | Fb | q |
|------------|-------|----------------|----------------|----------------|----------------|------|----------------|-------|------|
| | mm | mm | mm | mm | mm | mm | mm | N | kg/m |
| S45 | 41,4 | 22,23 | 15,24 | 5,72 | 28,58 | 17,3 | 38 | 29000 | 1,71 |
| S52 | 38,1 | 22,23 | 15,24 | 5,72 | 28,58 | 17,3 | 38 | 29000 | 1,80 |
| S55 | 41,4 | 22,23 | 17,78 | 5,72 | 28,58 | 17,3 | 38 | 29000 | 1,98 |
| S62 | 41,91 | 25,4 | 19,05 | 5,72 | 31,8 | 17,3 | 41 | 29000 | 2,29 |
| S88 | 66,27 | 28,58 | 22,86 | 8,28 | 37,5 | 26,2 | 50,8 | 60000 | 3,40 |



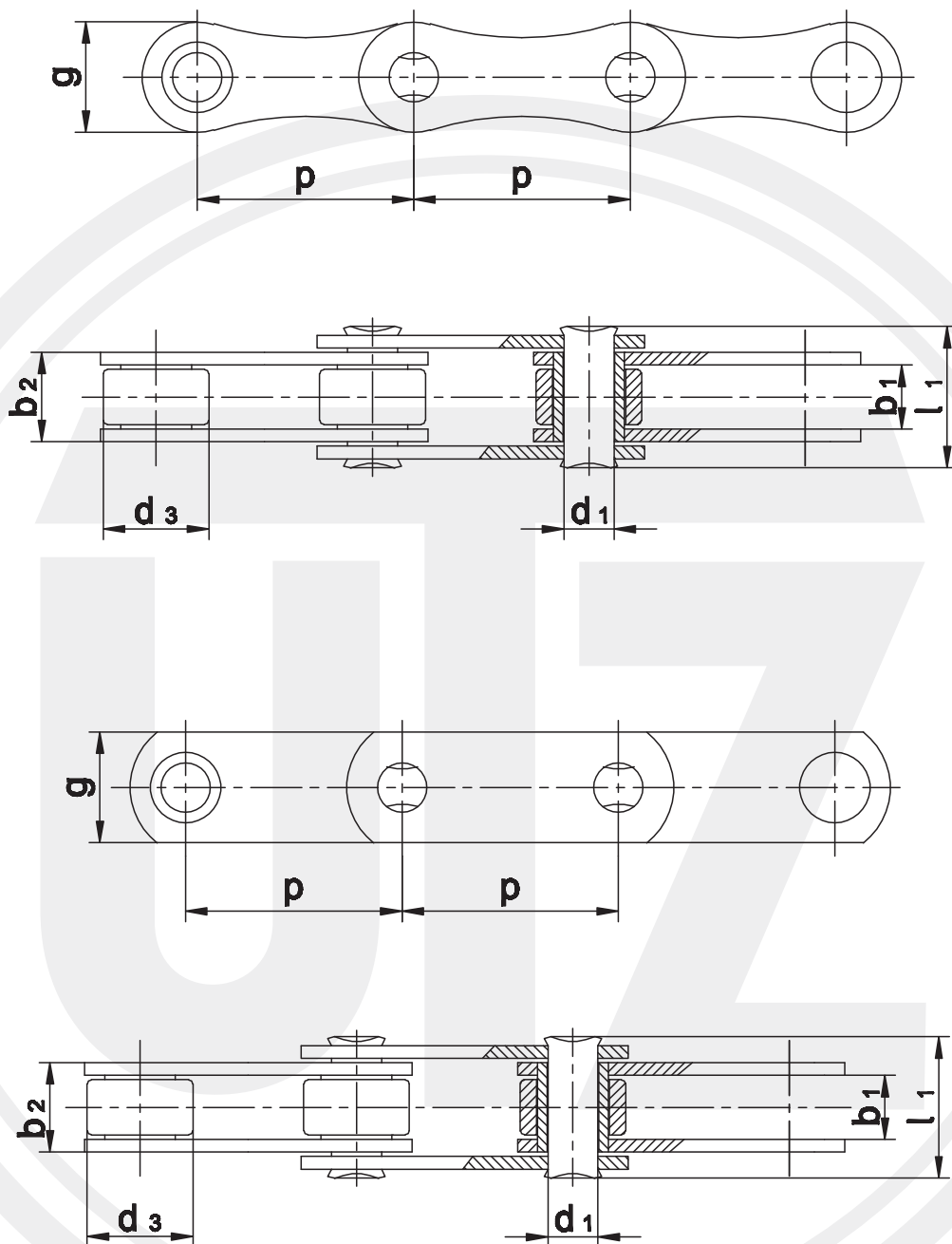

Napomena: naručivanje ovih lanaca kao i DIN 8189,
uz napomenu da treba naglasiti tvorničku normu





| p | b ₁ | d ₃ | d ₁ | b ₂ | g | l ₁ | Fb | q |
|------|----------------|----------------|----------------|----------------|------|----------------|-------|------|
| mm | mm | mm | mm | mm | mm | mm | N | kg/m |
| 30,0 | 19,0 | 15,88 | 8,28 | 25,45 | 20,0 | 36 | 45000 | 2,66 |
| 38,4 | 19,0 | 11,32 | 8,28 | 25,45 | 20,0 | 36 | 45000 | 1,93 |
| 38,4 | 19,0 | 15,88 | 8,28 | 25,45 | 20,0 | 36 | 45000 | 2,30 |
| 41,3 | 21,0 | 15,88 | 8,28 | 27,2 | 21,0 | 38 | 45000 | 1,96 |
| 41,4 | 22,23 | 15,88 | 8,28 | 30,5 | 22,0 | 43 | 60000 | 2,60 |
| 38,1 | 11,68 | 12,07 | 5,72 | 17,9 | 18,0 | 27,9 | 29000 | 1,59 |

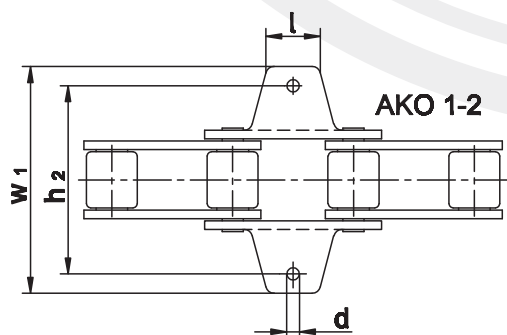
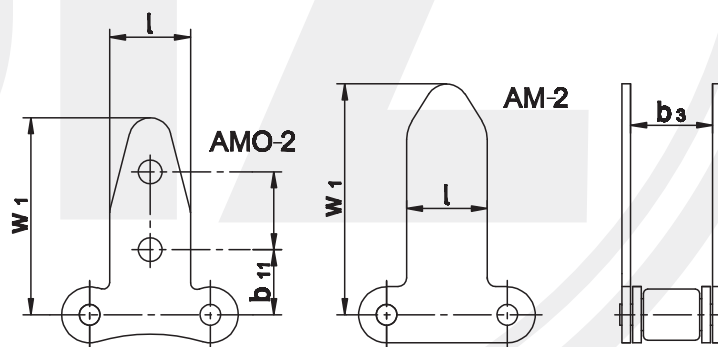
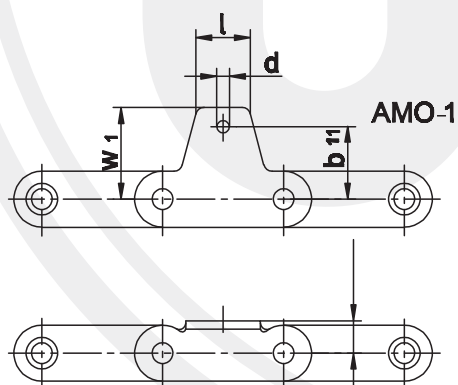
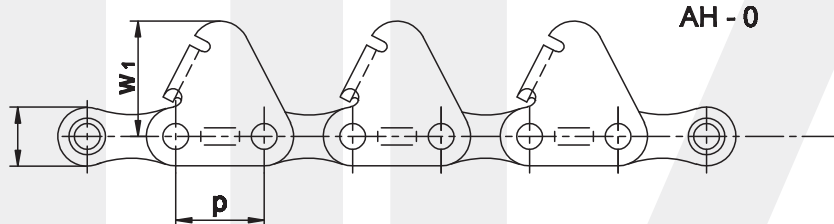
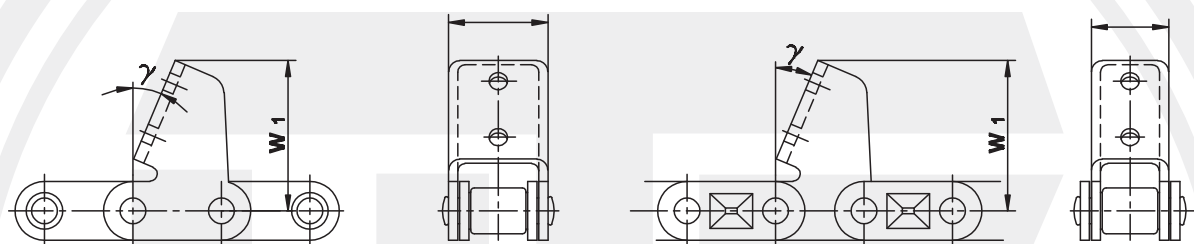
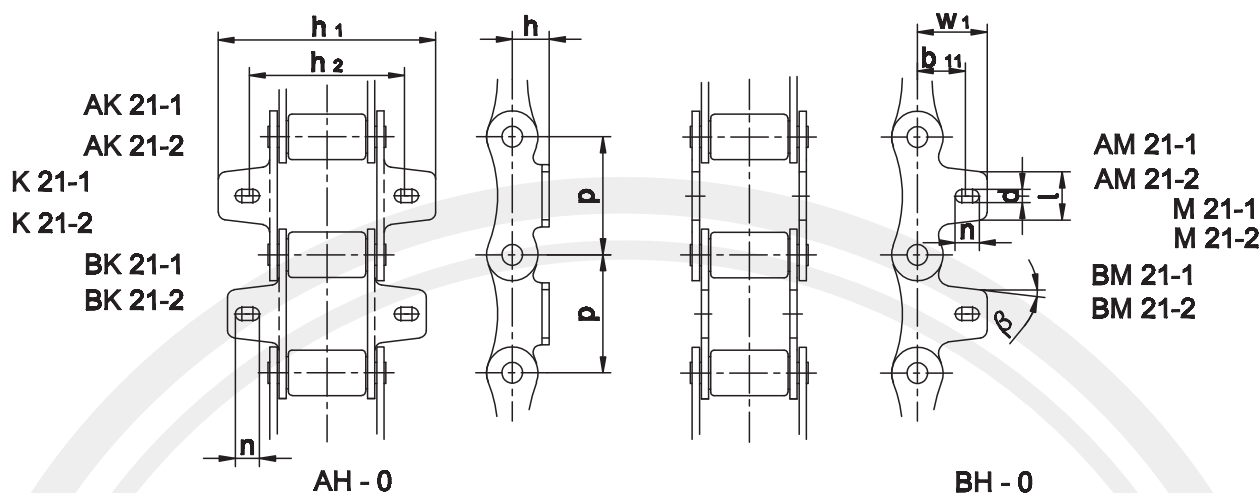

Napomena: udaljenost između nosivih spojnica na koraku lanca izraziti u mm ili kao "n" - ti članak.
Mjere na upit.

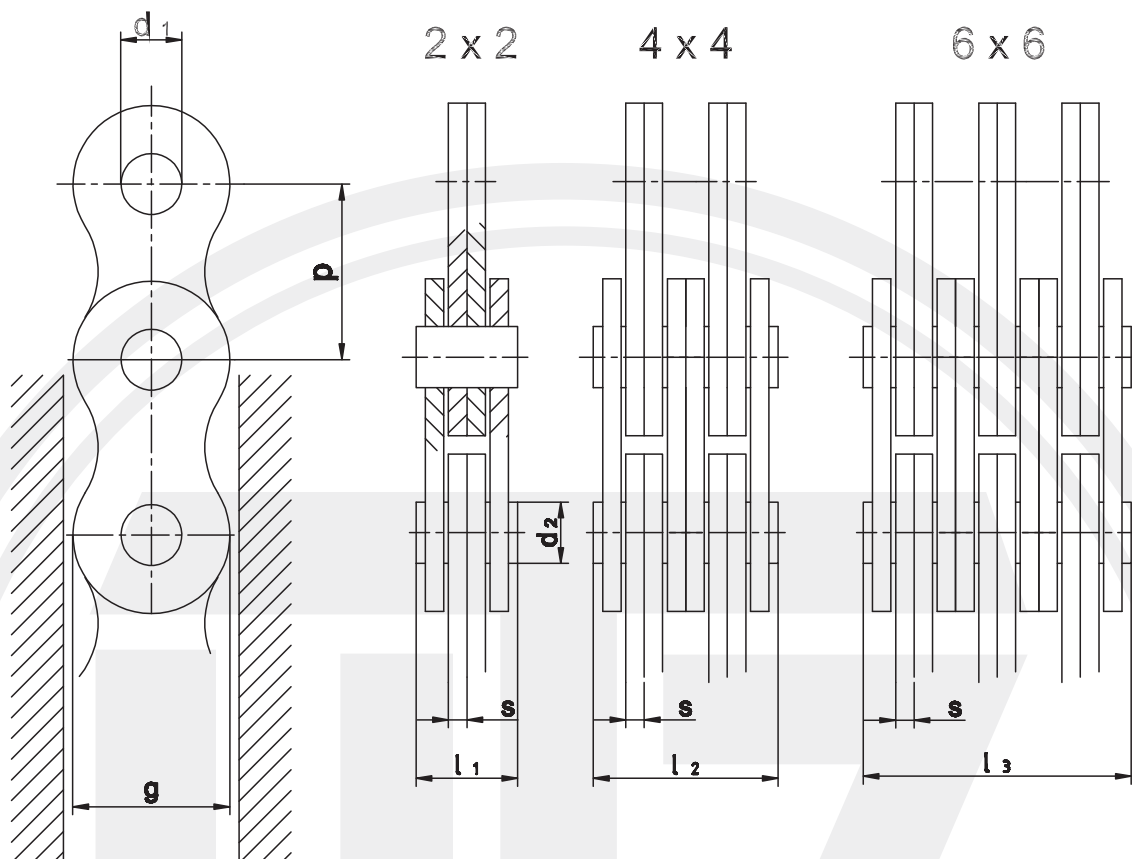

| BROJ LANCA | p | d ₁ | d ₂ | g | s | 2 x 2 | | | 4 x 4 | | | 6 x 6 | | |
|---------------|--------|----------------|----------------|------|-----|----------------|----------------|------|----------------|----------------|------|----------------|----------------|------|
| | | | | | | l ₁ | F _b | g | l ₁ | F _b | g | l ₁ | F _b | g |
| | | | | | | mm | N | kg/m | mm | N | kg/m | mm | N | kg/m |
| LL 08 | 12,7 | 4,46 | 4,45 | 10,9 | 1,6 | 9,2 | 18,200 | 0,4 | 16 | 36400 | 0,8 | 22,8 | 54600 | 1,2 |
| LL 10 | 15,875 | 5,09 | 5,08 | 13,7 | 1,6 | 9,3 | 22700 | 0,5 | 16,1 | 45400 | 1 | 22,9 | 68100 | 1,5 |
| LL 12 | 19,05 | 5,73 | 5,72 | 16,1 | 1,8 | 10,7 | 29500 | 0,7 | 18,5 | 59000 | 1,3 | 26,3 | 88500 | 2 |
| LL 16 | 25,4 | 8,29 | 8,28 | 21,1 | 3 | 17,2 | 58000 | 1,5 | 30,2 | 116000 | 3 | 43,2 | 174000 | 4,4 |
| LL 20 | 31,75 | 10,20 | 10,19 | 26,4 | 3,5 | 20,1 | 95000 | 2,3 | 35,1 | 190000 | 4,4 | 50,1 | 285000 | 6,6 |
| LL 24 | 38,1 | 14,65 | 14,63 | 33,4 | 5 | 28,4 | 170000 | 4,4 | 49,4 | 340000 | 8,5 | 70,4 | 510000 | 12,5 |
| LL 28 | 44,45 | 15,92 | 15,90 | 37,1 | 6 | 34 | 200000 | 5,4 | 60 | 400000 | 10,5 | 86 | 600000 | 15,5 |
| LL 32 | 50,8 | 17,83 | 17,81 | 42,3 | 6,3 | 35 | 260000 | 6,2 | 61 | 520000 | 12,1 | 87 | 780000 | 18 |
| LL 40 | 63,5 | 22,91 | 22,89 | 53 | 8 | 44,7 | 360000 | 10,3 | 77,9 | 720000 | 20 | 111,1 | 1080000 | 29,5 |
| LL 48 | 76,2 | 29,26 | 29,24 | 63,9 | 10 | 56,1 | 560000 | 18,5 | 97,4 | 1120000 | 35,7 | 138,9 | 1680000 | 53 |

PRIMJER ZA NARUDŽBU:

1. Narudžba pločastog lanca br. LL 16 sa kombinacijom spojnica 4 x 4:
PLOČASTI LANAC DIN 8152 - LL 1644

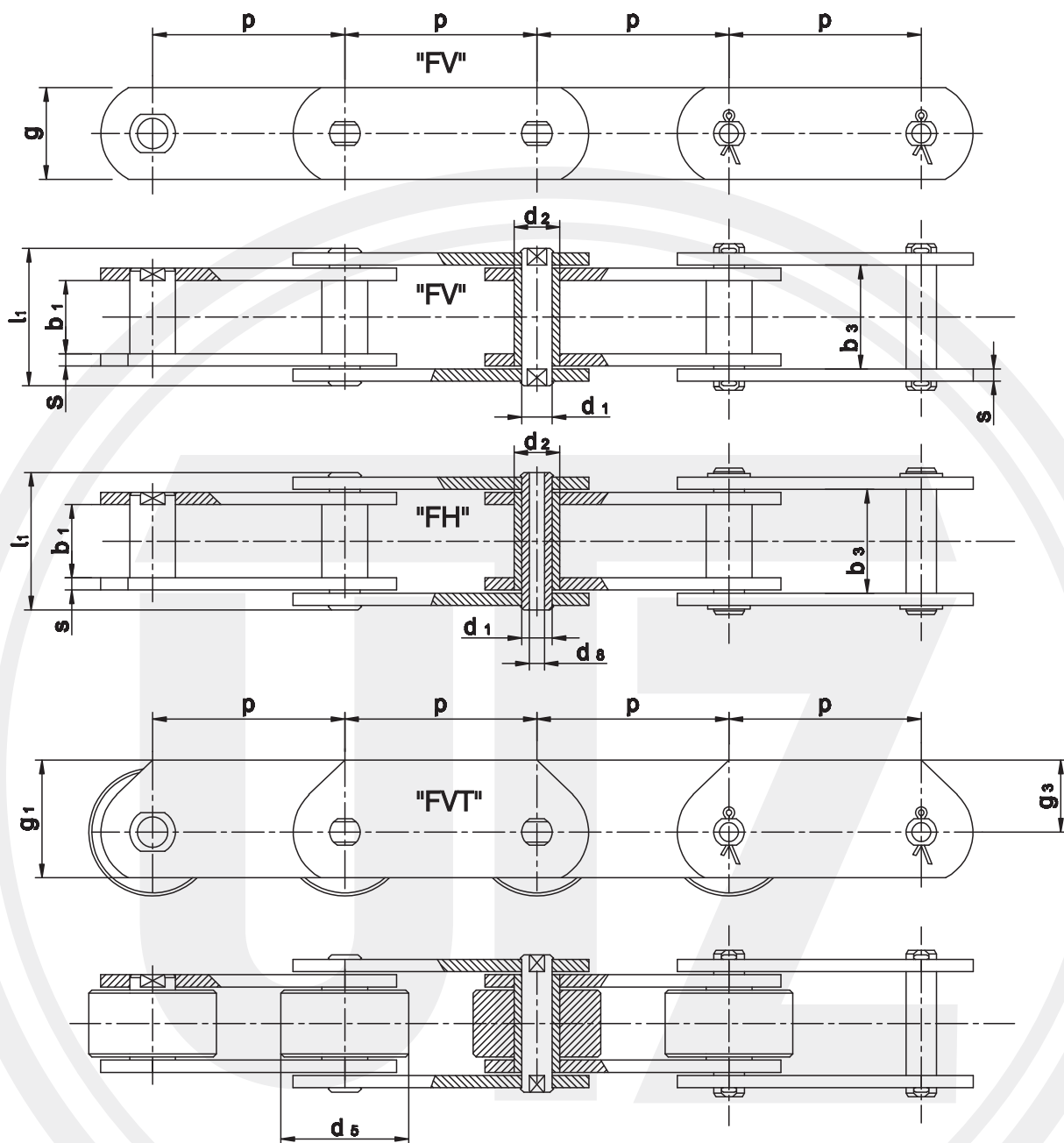

PRIMJERI ZA NARUDŽBU

1. Narudžba 5 metara jednostranog (1) tuljastog prijenosnog lanca sa oznakom FV 63, koraka 100 mm:
5 m PRIJENOSNOG LANCA DIN 8165-1 FV 63x100
2. Narudžba 5 metara jednostranog (1) prijenosnog lanca sa oznakom FV 63, koraka 100 mm i sa koturim tipa B:
5 m PRIJENOSNOG LANCA DIN 8165- B-1 FV 63x100
3. Narudžba 5 metara jednostranog (1) prijenosnog lanca sa povišenom spojnicom oznakom FVT 63, koraka 100 mm i sa koturim tipa B: 5 m PRIJENOSNOG LANCA
DIN 8165- B-1 FVT 63x100

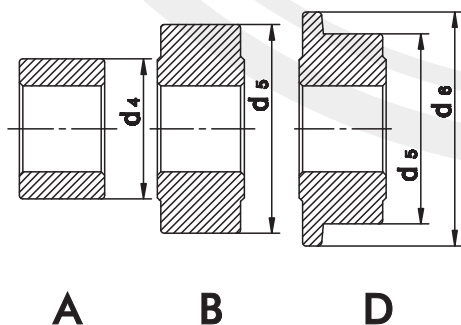

A

B

D





| OZNAKA LANCA | p | b ₁ | d ₂ | d ₁ | d ₃ | d ₄ | d ₅ | d ₅ /d ₆ | l ₁ | g | s | g ₁ | g ₃ | Fb | Fbh |
|-----------------|------|----------------|----------------|----------------|----------------|----------------|----------------|--------------------------------|----------------|-----|----|----------------|----------------|---------|--------|
| | mm | mm | mm | mm | mm | mm | mm | mm | mm | mm | mm | mm | mm | N | N |
| FV 40 | 40 | 18 | 15 | 10 | 6 | 20 | 32 | 40/48 | 37 | 26 | 3 | 35 | 22,0 | 40000 | 320000 |
| | 63 | | | | | | | 32/38 | | | | | | | |
| | 100 | | | | | | | | | | | | | | |
| FV 63 | 63 | 22 | 18 | 12 | 8 | 26 | 40 | 50/60 | 46 | 30 | 4 | 40 | 25,0 | 63000 | 45000 |
| | 100 | | | | | | | 40/48 | | | | | | | |
| | 125 | | | | | | | | | | | | | | |
| | 160 | | | | | | | | | | | | | | |
| FV 90 | 63 | 25 | 20 | 14 | 10 | 30 | 40 | 63/73 | 53 | 35 | 5 | 45 | 27,5 | 90000 | 56000 |
| | 100 | | | | | | | 48/56 | | | | | | | |
| | 125 | | | | | | | | | | | | | | |
| | 160 | | | | | | | | | | | | | | |
| | 200 | | | | | | | | | | | | | | |
| | 250 | | | | | | | | | | | | | | |
| FV 112 | 100 | 30 | 22 | 16 | 11 | 32 | 55 | 72/87 | 63 | 40 | 6 | 50 | 30,0 | 112000 | 80000 |
| | 125 | | | | | | | 55/65 | | | | | | | |
| | 160 | | | | | | | | | | | | | | |
| | 200 | | | | | | | | | | | | | | |
| | 250 | | | | | | | | | | | | | | |
| FV 140 | 100 | 35 | 26 | 18 | 12 | 36 | 60 | 80/95 | 68 | 45 | 6 | 60 | 37,5 | 140000 | 102000 |
| | 125 | | | | | | | 60/70 | | | | | | | |
| | 160 | | | | | | | | | | | | | | |
| | 200 | | | | | | | | | | | | | | |
| | 250 | | | | | | | | | | | | | | |
| | 315 | | | | | | | | | | | | | | |
| FV 180 | 125 | 45 | 30 | 20 | 14 | 42 | 70 | 100/120 | 86 | 50 | 8 | 70 | 45,0 | 180000 | 145000 |
| | 160 | | | | | | | 70/85 | | | | | | | |
| | 200 | | | | | | | | | | | | | | |
| | 250 | | | | | | | | | | | | | | |
| | 315 | | | | | | | | | | | | | | |
| | 400 | | | | | | | | | | | | | | |
| FV 250 | 125 | 55 | 36 | 26 | 18 | 50 | 80 | 125/145 | 98 | 60 | 8 | 80 | 50,0 | 250000 | 215000 |
| | 160 | | | | | | | 80/95 | | | | | | | |
| | 200 | | | | | | | | | | | | | | |
| | 250 | | | | | | | | | | | | | | |
| | 315 | | | | | | | | | | | | | | |
| | 400 | | | | | | | | | | | | | | |
| FV 315 | 160 | 65 | 42 | 30 | 20 | 60 | 90 | 140/170 | 117 | 70 | 10 | 90 | 55,0 | 315000 | 295000 |
| | 200 | | | | | | | 90/110 | | | | | | | |
| | 250 | | | | | | | | | | | | | | |
| | 315 | | | | | | | | | | | | | | |
| | 400 | | | | | | | | | | | | | | |
| FV 400 | 160 | 70 | 44 | 32 | 22 | 60 | 100 | 150/180 | 131 | 70 | 12 | 90 | 55,0 | 400000 | 330000 |
| | 200 | | | | | | | 100/120 | | | | | | | |
| | 250 | | | | | | | | | | | | | | |
| | 315 | | | | | | | | | | | | | | |
| | 400 | | | | | | | | | | | | | | |
| FV 500 | 160 | 80 | 50 | 36 | 26 | 70 | 110 | 160/195 | 141 | 80 | 12 | 100 | 60,0 | 500000 | 440000 |
| | 200 | | | | | | | 110/130 | | | | | | | |
| | 250 | | | | | | | | | | | | | | |
| | 315 | | | | | | | | | | | | | | |
| | 400 | | | | | | | | | | | | | | |
| FV 630 | 200 | 90 | 56 | 42 | 30 | 80 | 120 | 170/210 | 153 | 100 | 12 | 120 | 70,0 | 630000 | 520000 |
| | 250 | | | | | | | 120/140 | | | | | | | |
| | 315 | | | | | | | | | | | | | | |
| | 400 | | | | | | | | | | | | | | |
| | 500 | | | | | | | | | | | | | | |
| FV 900 | 250 | 100 | 60 | 42 | 30 | 80 | 130 | 180/220 | 165 | 100 | 12 | - | - | 900000 | - |
| | 315 | | | | | | | 130/160 | | | | | | | |
| | 400 | | | | | | | | | | | | | | |
| | 500 | | | | | | | | | | | | | | |
| FV 1200 | 315 | 125 | 70 | 50 | 36 | 90 | 150 | 200/240 | 195 | 120 | 15 | - | - | 1200000 | - |
| | 400 | | | | | | | 150/190 | | | | | | | |
| | 500 | | | | | | | | | | | | | | |
| | 1000 | | | | | | | | | | | | | | |

Napomena: vučna sila je 1/6 od prekidne sile $\left(\frac{F_b}{6}\right)$

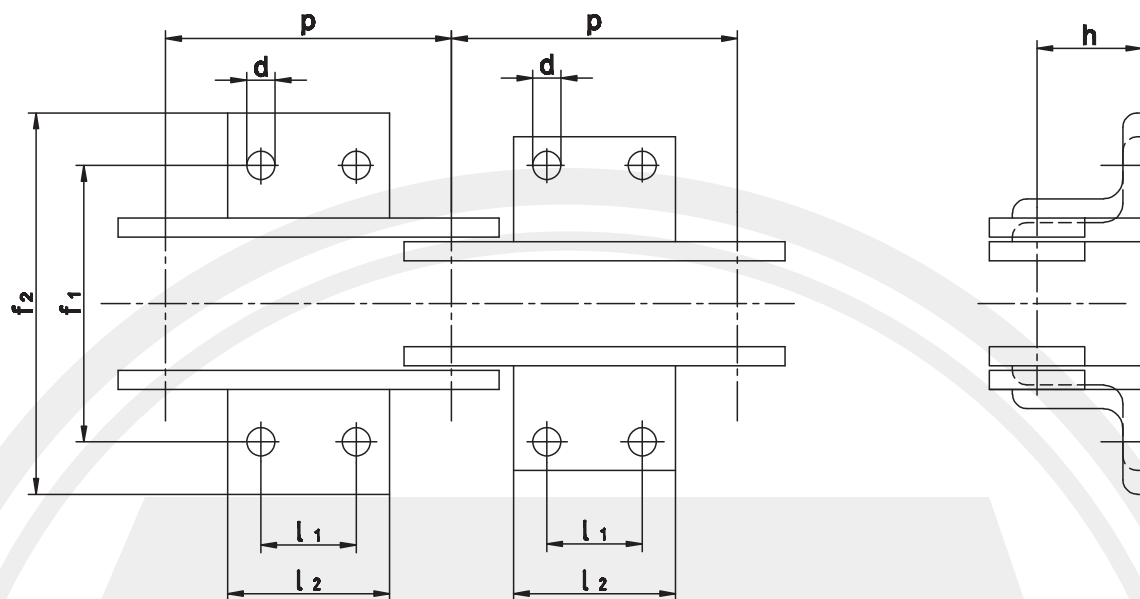

Mjere u mm

| Lanac br. | | p | | | | | | | | | d | f ₁ | f ₂ max. | h | Kutnik DIN 1028 |
|-----------|--------------------|----|-----|-----|-----|-----|-----|-----|-----|-----|-----|----------------|------------------------|----|--------------------|
| | | 63 | 100 | 125 | 160 | 200 | 250 | 315 | 400 | 500 | | | | | |
| FV 40 | l ₁ | | 30 | | | | | | | | 6,6 | 50 | 82 | 20 | 25x3 |
| | l ₂ max | 31 | 50 | | | | | | | | | | | | |
| FV 63 | l ₁ | | 30 | 40 | 50 | | | | | | 9 | 68 | 100 | 30 | 30x3 |
| | l ₂ max | 40 | 50 | 60 | 70 | | | | | | | | | | |
| FV 90 | l ₁ | | 30 | 40 | 50 | 60 | 65 | | | | 9 | 80 | 127 | 35 | 40x4 |
| | l ₂ max | | 50 | 60 | 70 | 80 | 85 | | | | | | | | |
| FV 112 | l ₁ | | 30 | 40 | 50 | 65 | 80 | | | | 11 | 100 | 136 | 40 | 40x5 |
| | l ₂ max | | 50 | 65 | 75 | 90 | 105 | | | | | | | | |
| FV 140 | l ₁ | | 30 | 40 | 50 | 65 | 80 | 100 | | | 11 | 100 | 161 | 45 | 50x5 |
| | l ₂ max | | 55 | 65 | 75 | 90 | 105 | 125 | | | | | | | |
| FV 80 | l ₁ | | | 35 | 50 | 65 | 80 | 100 | 100 | | 14 | 128 | 180 | 45 | 50x6 |
| | l ₂ max | | | 65 | 80 | 95 | 110 | 130 | 130 | | | | | | |
| FV 250 | l ₁ | | | | 50 | 65 | 80 | 100 | 100 | | 14 | 138 | 220 | 55 | 65x7 |
| | l ₂ max | | | 50 | 80 | 95 | 110 | 130 | 130 | | | | | | |
| FV 315 | l ₁ | | | | | 65 | 80 | 100 | 100 | | 14 | 170 | 248 | 60 | 70x9 |
| | l ₂ max | | | | 50 | 95 | 110 | 130 | 130 | | | | | | |
| FV 400 | l ₁ | | | | | 60 | 80 | 100 | 100 | | 18 | 190 | 280 | 65 | 80x10 |
| | l ₂ max | | | | 50 | 100 | 120 | 140 | 140 | | | | | | |
| FV 500 | l ₁ | | | | | 50 | 80 | 100 | 100 | 100 | 18 | 200 | 290 | 70 | 80x10 |
| | l ₂ max | | | | 50 | 90 | 120 | 140 | 140 | 140 | | | | | |
| FV 630 | l ₁ | | | | | | 70 | 100 | 100 | 100 | 18 | 230 | 340 | 80 | 100x10 |
| | l ₂ max | | | | | 50 | 110 | 140 | 140 | 140 | | | | | |

Materijal izrade. St 37-2 DIN 17100; za savijene nosive spojnice čelik vlačne čvrstoće 600 MPa.
Izvedba: za "f₁", "h", "l" dopuštena odstupanja prema DIN 2768- grubo; za "d" prema DIN 69
- srednje

Pri narudžbi posebno navesti broj i raspored nosivih spojnica: na vanjskom ili unutarnjem članku
s jedne ili obje strane lanca.



| OZNAKA LANCA | p mm | kg/m tulj. lanac | kg/m A | kg/m B | kg/m D |
|---------------|------|---------------------|-----------|-----------|-----------|
| FV 40 | 40 | 2,59 | 3,04 | 4,68 | |
| | 63 | 2,08 | 2,63 | 3,43 | 4,65/3,44 |
| | 100 | 1,76 | 1,94 | 2,60 | 3,38/2,62 |
| FV 63 | 63 | 3,46 | 4,17 | 6,08 | -/6,54 |
| | 100 | 2,92 | 3,37 | 4,57 | 5,6/4,68 |
| | 125 | 2,67 | 3,03 | 3,97 | 4,82/4,02 |
| | 160 | 2,45 | 2,73 | 3,48 | 4,13/3,50 |
| FV 90 | 63 | 6,0 | 6,87 | 10,0 | -/7,62 |
| | 100 | 4,67 | 5,40 | 7,37 | 9,59/7,41 |
| | 125 | 4,37 | 4,93 | 6,51 | 8,29/6,29 |
| | 160 | 3,87 | 4,32 | 5,56 | 6,95/5,42 |
| | 200 | 3,5 | 3,86 | 4,85 | 5,96/4,75 |
| | 250 | 3,47 | 3,76 | 4,55 | 5,44/4,22 |
| FV 112 | 100 | 6,11 | 7,06 | 10,5 | 14,3/11,4 |
| | 125 | 5,85 | 6,61 | 9,39 | 12,4/9,70 |
| | 160 | 5,26 | 5,85 | 8,03 | 10,4/8,17 |
| | 200 | 5,0 | 5,47 | 7,30 | 9,13/7,10 |
| | 250 | 4,72 | 5,1 | 6,49 | 8,02/6,28 |
| FV 140 | 100 | 7,38 | 8,69 | 13,3 | -/14,6 |
| | 125 | 6,78 | 7,36 | 10,2 | 13,5/12,3 |
| | 160 | 6,56 | 7,36 | 10,2 | 13,5/10,3 |
| | 200 | 5,82 | 6,46 | 8,77 | 11,4/8,92 |
| | 250 | 5,48 | 5,99 | 7,85 | 9,96/7,72 |
| | 315 | 5,28 | 5,68 | 7,25 | 8,25/6,80 |
| FV 180 | 125 | 10,7 | 12,5 | 19,2 | -/21,7 |
| | 160 | 9,72 | 11,2 | 16,3 | 22,2/17,9 |
| | 200 | 9,12 | 10,0 | 14,4 | 19,1/15,3 |
| | 250 | 8,51 | 9,43 | 12,7 | 16,9/12,3 |
| | 315 | 8,2 | 8,93 | 11,6 | 14,5/11,3 |
| | 400 | 7,64 | 8,22 | 10,3 | 12,6/9,50 |

| OZNAKA LANCA | p mm | kg/m tulj. lanac | kg/m A | kg/m B | kg/m D |
|---------------|------|---------------------|-----------|-----------|------------|
| FV 250 | 125 | 14,3 | 17,5 | 27,5 | - |
| | 160 | 13,0 | 15,5 | 23,4 | 39,9/17,0 |
| | 200 | 11,8 | 13,8 | 20,6 | 33,3/22,5 |
| | 250 | 10,8 | 12,4 | 17,4 | 28,0/19,0 |
| | 315 | 10,0 | 11,2 | 15,2 | 23,6/16,1 |
| | 400 | 9,6 | 10,6 | 13,7 | 20,3/13,7 |
| FV 315 | 160 | 20,4 | 24,5 | 35,67 | - |
| | 200 | 18,4 | 21,8 | 20,74 | 43,59/34,9 |
| | 250 | 16,79 | 19,6 | 26,79 | 37,07/29,6 |
| | 315 | 15,53 | 17,8 | 23,46 | 32,62/24,6 |
| | 400 | 14,56 | 16,35 | 20,81 | 27,23/23,5 |
| FV 400 | 160 | 24,6 | 28,52 | 45,58 | - |
| | 200 | 21,91 | 25,40 | 39,05 | 56,11/43,9 |
| | 250 | 20,17 | 22,96 | 33,38 | 47,53/36,8 |
| | 315 | 18,73 | 20,95 | 29,61 | 40,44/31,1 |
| | 400 | 17,56 | 19,31 | 26,12 | 34,66/26,3 |
| FV 500 | 160 | 30,04 | 37,18 | 58,9 | - |
| | 200 | 27,04 | 32,75 | 50,13 | -/57,0 |
| | 250 | 24,65 | 29,22 | 43,12 | 55,48/47,6 |
| | 315 | 22,68 | 26,3 | 37,34 | 47,14/29,9 |
| | 400 | 21,06 | 23,91 | 32,6 | 40,33/33,7 |
| FV 630 | 200 | 36,45 | 45,22 | 67,25 | - |
| | 250 | 32,93 | 39,95 | 57,57 | 76,2/63,2 |
| | 315 | 30,02 | 35,59 | 49,57 | 64,36/52,3 |
| | 400 | 27,65 | 32,04 | 43,05 | 54,69/44,5 |
| | 500 | 25,88 | 29,39 | 38,2 | 47,52/38,3 |

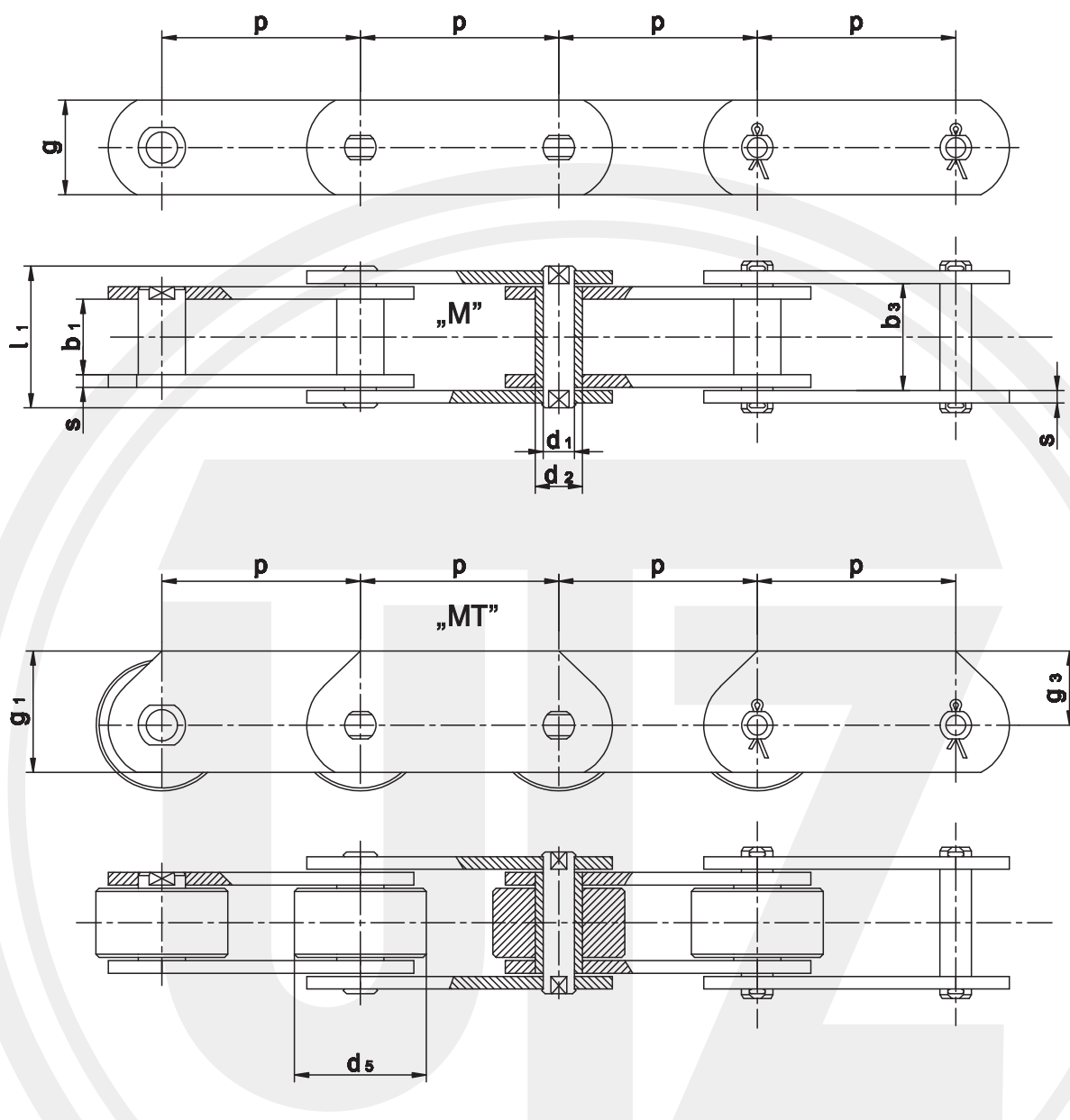

PRIMJERI ZA NARUDŽBU:

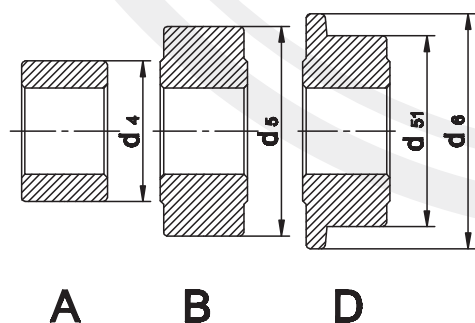

1. Narudžba 5 metara jednostrukog (1) tuljčastog prijenosnog lanca sa oznakom M 80, koraka 100mm:
5 m PRIJENOSNOG LANCA DIN 8167-1 M 80 x 100
2. Narudžba 5 metara jednostranog (1) prijenosnog lanca sa oznakom M 80, koraka 100 mm i sa koturom tipa B:
5 m PRIJENOSNOG LANCA DIN 8167 - B 1 M 80 x 100
3. Narudžba 5 metara jednostranog (1) prijenosnog lanca sa povišenom spojnicom oznake 80 MT, koraka 100 mm i sa koturom tipa B/A ili D:
5 m PRIJENOSNOG LANCA DIN 8167 - B 1 M T 80 x 100

Napomena: radimo i lance sa šupljim svornjacima DIN 8168



| OZNAKA LANCA | p mm | b ₁ mm | d ₂ mm | d ₁ mm | d ₄ mm | d ₅ mm | d ₅ /d ₆ mm | l ₁ mm | g mm | s mm | g ₁ mm | g ₂ mm | F _b N |
|--------------|---------|----------------------|----------------------|----------------------|----------------------|----------------------|--------------------------------------|----------------------|---------|---------|----------------------|----------------------|---------------------|
| M 20 | 40 | 16 | 9,0 | 6,0 | 6,0 | 25 | 25/30 | 31,5 | 18 | 2,0 | 25 | 16,0 | 20000 |
| | 50 | | | | | | | | | | | | |
| | 63 | | | | | | | | | | | | |
| | 80 | | | | | | | | | | | | |
| | 100 | | | | | | | | | | | | |
| | 125 | | | | | | | | | | | | |
| | 160 | | | | | | | | | | | | |
| M 28 | 50 | 18 | 10,0 | 7,0 | 7,0 | 30 | 30/36 | 36,0 | 20 | 3,0 | 30 | 20,0 | 28000 |
| | 63 | | | | | | | | | | | | |
| | 80 | | | | | | | | | | | | |
| | 100 | | | | | | | | | | | | |
| | 125 | | | | | | | | | | | | |
| | 160 | | | | | | | | | | | | |
| | 200 | | | | | | | | | | | | |
| M 40 | 63 | 20 | 12,5 | 8,5 | 8,5 | 36 | 36/42 | 40,5 | 25 | 3,5 | 35 | 22,5 | 40000 |
| | 80 | | | | | | | | | | | | |
| | 100 | | | | | | | | | | | | |
| | 125 | | | | | | | | | | | | |
| | 160 | | | | | | | | | | | | |
| | 200 | | | | | | | | | | | | |
| | 250 | | | | | | | | | | | | |
| M 56 | 63 | 24 | 15,0 | 10,0 | 10,0 | 42 | 42/50 | 47,0 | 30 | 4,0 | 45 | 30,0 | 56000 |
| | 80 | | | | | | | | | | | | |
| | 100 | | | | | | | | | | | | |
| | 125 | | | | | | | | | | | | |
| | 160 | | | | | | | | | | | | |
| | 200 | | | | | | | | | | | | |
| | 250 | | | | | | | | | | | | |
| M 80 | 80 | 28 | 18,0 | 12,0 | 12,0 | 50 | 50/60 | 57,0 | 35 | 5,0 | 50 | 32,5 | 80000 |
| | 100 | | | | | | | | | | | | |
| | 125 | | | | | | | | | | | | |
| | 160 | | | | | | | | | | | | |
| | 200 | | | | | | | | | | | | |
| | 250 | | | | | | | | | | | | |
| | 315 | | | | | | | | | | | | |
| M 112 | 80 | 32 | 21,0 | 15,0 | 15,0 | 60 | 60/70 | 65,0 | 40 | 6,0 | 60 | 40,0 | 112000 |
| | 100 | | | | | | | | | | | | |
| | 125 | | | | | | | | | | | | |
| | 160 | | | | | | | | | | | | |
| | 200 | | | | | | | | | | | | |
| | 250 | | | | | | | | | | | | |
| | 315 | | | | | | | | | | | | |
| | 400 | | | | | | | | | | | | |
| M 160 | 100 | 37 | 25,0 | 18,0 | 18,0 | 70 | 70/85 | 75,0 | 50 | 7,0 | 70 | 45,0 | 160000 |
| | 125 | | | | | | | | | | | | |
| | 160 | | | | | | | | | | | | |
| | 200 | | | | | | | | | | | | |
| | 250 | | | | | | | | | | | | |
| | 315 | | | | | | | | | | | | |
| | 400 | | | | | | | | | | | | |
| | 500 | | | | | | | | | | | | |
| M 224 | 125 | 43 | 30,0 | 21,0 | 21,0 | 85 | 85/100 | 88,0 | 60 | 8,0 | 90 | 60,0 | 224000 |
| | 160 | | | | | | | | | | | | |
| | 200 | | | | | | | | | | | | |
| | 250 | | | | | | | | | | | | |
| | 315 | | | | | | | | | | | | |
| | 400 | | | | | | | | | | | | |
| | 500 | | | | | | | | | | | | |
| | 630 | | | | | | | | | | | | |
| M 315 | 160 | 48 | 36,0 | 25,0 | 25,0 | 100 | 100/120 | 100,0 | 70 | 10,0 | 100 | 65,0 | 315000 |
| | 200 | | | | | | | | | | | | |
| | 250 | | | | | | | | | | | | |
| | 315 | | | | | | | | | | | | |
| | 400 | | | | | | | | | | | | |
| | 500 | | | | | | | | | | | | |
| | 630 | | | | | | | | | | | | |
| M 450 | 200 | 56 | 42,0 | 30,0 | 30,0 | 120 | 120/140 | 116,0 | 80 | 12,0 | 120 | 80,0 | 450000 |
| | 250 | | | | | | | | | | | | |
| | 315 | | | | | | | | | | | | |
| | 400 | | | | | | | | | | | | |
| | 500 | | | | | | | | | | | | |
| | 630 | | | | | | | | | | | | |
| | 800 | | | | | | | | | | | | |
| M 630 | 250 | 66 | 50,0 | 36,0 | 36,0 | 140 | 140/170 | 140,0 | 100 | 14,0 | 140 | 90,0 | 530000 |
| | 315 | | | | | | | | | | | | |
| | 400 | | | | | | | | | | | | |
| | 500 | | | | | | | | | | | | |
| | 630 | | | | | | | | | | | | |
| | 800 | | | | | | | | | | | | |
| | 1000 | | | | | | | | | | | | |
| M 900 | 250 | 78 | 60,0 | 44,0 | 44,0 | 170 | 170/210 | 164,0 | 120 | 16,0 | 180 | 120,0 | 900000 |
| | 315 | | | | | | | | | | | | |
| | 400 | | | | | | | | | | | | |
| | 500 | | | | | | | | | | | | |
| | 630 | | | | | | | | | | | | |
| | 800 | | | | | | | | | | | | |
| | 1000 | | | | | | | | | | | | |

Napomena: vučna sila je 1/7 od prekidne sile $\left(\frac{F_b}{7}\right)$

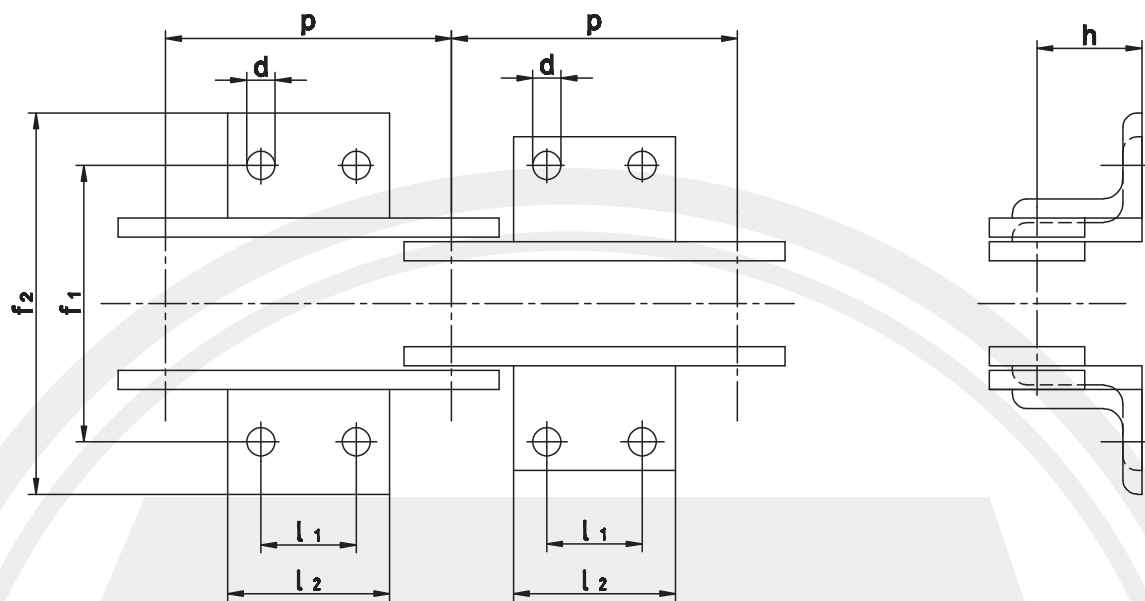

Mjere u mm

| Lanac br. | | 50 | 63 | 80 | 100 | 125 | 160 | 200 | 250 | | d | f ₁ | f ₂ | h | kutnik DIN 1028 |
|-----------|--------|----|----|----|-----|-----|-----|-----|-----|-----|-----|----------------|----------------|-----|---------------------|
| M 20 | L1 | | 20 | 35 | 50 | 50 | 50 | | | | 6,6 | 54 | 84 | 16 | 25x3 |
| | L2 max | 14 | 35 | 50 | 65 | 65 | 65 | | | | | | | | |
| M 28 | L1 | | | 25 | 40 | 55 | 65 | 65 | | | 9 | 64 | 100 | 20 | 30x20x3 DIN 1029 |
| | L2 max | 20 | 20 | 45 | 60 | 85 | 85 | 85 | | 315 | | | | | |
| M 40 | L1 | | | 20 | 40 | 65 | 65 | 65 | 65 | | 9 | 70 | 112 | 25 | 30x3 |
| | L2 max | | 20 | 40 | 60 | 85 | 85 | 85 | 85 | | | | | | |
| M 56 | L1 | | | | 25 | 50 | 85 | 85 | 85 | | 11 | 78 | 140 | 30 | 40x3 |
| | L2 max | | 22 | 22 | 50 | 75 | 110 | 110 | 110 | | | | | | |
| M 80 | L1 | | | | | 50 | 85 | 125 | 125 | 125 | 11 | 96 | 160 | 35 | 40x4 |
| | L2 max | | | 22 | 22 | 75 | 110 | 150 | 150 | 150 | | | | | |
| M 112 | L1 | | | | | 35 | 65 | 100 | 100 | 100 | 14 | 110 | 184 | 40 | 50x6 |
| | L2 max | | | 28 | 28 | 65 | 95 | 130 | 130 | 130 | | | | | |
| M 160 | L1 | | | | | | 50 | 85 | 145 | 145 | 14 | 124 | 200 | 45 | 50x6 |
| | L2 max | | | | 30 | 30 | 80 | 115 | 175 | 175 | | | | | |
| M 224 | L1 | | | | | | | 65 | 125 | 190 | 18 | 140 | 228 | 55 | 60x8 |
| | L2 max | | | | | 35 | 35 | 100 | 160 | 225 | | | | | |
| M 315 | L1 | | | | | | | 50 | 100 | 155 | 18 | 160 | 250 | 65 | 70x9 |
| | L2 max | | | | | | 35 | 85 | 135 | 190 | | | | | |
| M 450 | L1 | | | | | | | | 85 | 155 | 18 | 180 | 280 | 75 | 70x9 |
| | L2 max | | | | | | | | 125 | 195 | | | | | |
| M 630 | L1 | | | | | | | | | 100 | 24 | 230 | 380 | 90 | 100x12 |
| | L2 max | | | | | | | | 50 | 150 | | | | | |
| M 900 | L1 | | | | | | | | | 65 | 30 | 280 | 480 | 110 | 120x15 |
| | L2 max | | | | | | | | 60 | 125 | | | | | |

Materijal izrade. St 37-2 DIN 17100; za savijene nosive spojnice čelik vlačne čvrstoće 600 MPa.
Izvedba: za "f₁", "h₁", "l₁" dopuštena odstupanja prema DIN 2768- grubo; za "d" prema DIN 69
- srednje

Pri narudžbi posebno navesti broj i raspored nosivih spojnica: na vanjskom ili unutarnjem članku
s jedne ili obje strane lanca.



| OZNAKA LANCA | p mm | kg/m tulj. lanac | kg/m A | kg/m B | kg/m D |
|--------------|------|---------------------|-----------|-----------|-----------|
| M 20 | 40 | 1,08 | 1,44 | 2,61 | 2,81 |
| | 50 | 1,01 | 1,29 | 2,23 | 2,39 |
| | 63 | 0,99 | 1,23 | 2,0 | 2,13 |
| | 80 | 0,9 | 1,07 | 1,67 | 1,77 |
| | 100 | 0,86 | 1,0 | 1,47 | 1,55 |
| | 125 | 0,82 | 0,95 | 1,32 | 1,38 |
| M 28 | 160 | 0,8 | 0,89 | 1,19 | 1,24 |
| | 50 | 1,54 | 1,82 | 3,32 | 3,52 |
| | 63 | 1,42 | 1,64 | 2,84 | 3,0 |
| | 80 | 1,32 | 1,5 | 2,44 | 2,57 |
| | 100 | 1,24 | 1,38 | 2,13 | 2,23 |
| | 125 | 1,18 | 1,3 | 1,9 | 1,98 |
| M 40 | 160 | 1,13 | 1,22 | 1,69 | 1,75 |
| | 200 | 1,1 | 1,17 | 1,54 | 1,59 |
| | 63 | 2,24 | 2,57 | 4,47 | 4,7 |
| | 80 | 1,98 | 2,25 | 3,75 | 3,95 |
| | 100 | 1,91 | 2,12 | 3,32 | 3,47 |
| | 125 | 1,81 | 1,98 | 2,93 | 3,06 |
| M 56 | 160 | 1,71 | 1,85 | 2,6 | 2,71 |
| | 200 | 1,64 | 1,75 | 2,35 | 2,42 |
| | 250 | 1,6 | 1,68 | 2,16 | 2,23 |
| | 63 | 3,32 | 3,38 | 6,93 | 7,26 |
| | 80 | 3,01 | 3,41 | 5,86 | 6,2 |
| | 100 | 2,79 | 3,11 | 5,07 | 5,34 |
| M 80 | 125 | 2,79 | 2,87 | 4,43 | 4,65 |
| | 160 | 2,44 | 2,64 | 3,87 | 4,04 |
| | 200 | 2,34 | 2,5 | 3,49 | 3,63 |
| | 250 | 2,25 | 2,37 | 3,16 | 3,27 |
| | 80 | 4,65 | 5,29 | 9,36 | 9,95 |
| | 100 | 4,27 | 4,79 | 8,03 | 8,5 |
| M 112 | 125 | 3,97 | 4,38 | 6,98 | 7,35 |
| | 160 | 3,70 | 4,03 | 6,05 | 6,35 |
| | 200 | 3,51 | 3,77 | 5,39 | 5,63 |
| | 250 | 3,37 | 3,57 | 4,87 | 5,06 |
| | 315 | 3,24 | 3,41 | 4,43 | 4,58 |
| | 80 | 6,75 | 7,88 | 14,6 | 15,3 |
| M 160 | 100 | 6,15 | 7,06 | 12,4 | 13,0 |
| | 125 | 5,69 | 6,42 | 10,7 | 11,2 |
| | 160 | 5,26 | 5,83 | 9,15 | 9,54 |
| | 200 | 4,97 | 5,43 | 8,09 | 8,38 |
| | 315 | 4,53 | 4,82 | 6,52 | 6,70 |
| | 400 | 4,38 | 4,61 | 5,94 | 6,08 |
| M 250 | 500 | 4,74 | 5,1 | 7,22 | 7,47 |

| OZNAKA LANCA | p mm | kg/m tulj. lanac | kg/m A | kg/m B | kg/m D |
|--------------|------|---------------------|-----------|-----------|-----------|
| M 160 | 100 | 9,7 | 11,2 | 19,5 | 20,4 |
| | 125 | 8,85 | 10,1 | 16,7 | 17,5 |
| | 160 | 8,15 | 9,12 | 14,3 | 14,9 |
| | 200 | 7,56 | 8,33 | 12,5 | 13,0 |
| | 250 | 7,22 | 7,82 | 11,1 | 11,5 |
| | 315 | 6,88 | 7,38 | 9,95 | 10,3 |
| M 250 | 400 | 6,57 | 6,95 | 9,0 | 9,25 |
| | 500 | 6,36 | 6,68 | 8,35 | 8,25 |
| | 125 | 13,1 | 14,9 | 26,6 | 27,3 |
| | 160 | 11,9 | 13,3 | 22,4 | 23,4 |
| | 200 | 11,1 | 12,2 | 19,5 | 20,3 |
| | 250 | 10,3 | 11,2 | 17,1 | 17,7 |
| M 315 | 315 | 9,78 | 10,5 | 15,1 | 15,7 |
| | 400 | 9,30 | 9,86 | 13,5 | 13,9 |
| | 500 | 8,97 | 9,4 | 12,3 | 12,6 |
| | 630 | 8,67 | 9,02 | 11,3 | 11,6 |
| | 160 | 18,3 | 20,5 | 34,4 | 36,1 |
| | 200 | 17,7 | 18,6 | 29,6 | 31,0 |
| M 450 | 250 | 15,6 | 17,1 | 25,9 | 27,1 |
| | 315 | 14,6 | 15,8 | 22,9 | 23,7 |
| | 400 | 13,9 | 14,8 | 20,3 | 21,2 |
| | 500 | 13,3 | 14,1 | 18,5 | 19,1 |
| | 630 | 12,8 | 13,4 | 16,9 | 17,4 |
| | 200 | 24,2 | 27,5 | 46,0 | 47,8 |
| M 630 | 250 | 22,4 | 25,0 | 39,8 | 41,4 |
| | 315 | 20,9 | 22,9 | 34,7 | 36,0 |
| | 400 | 19,7 | 21,3 | 30,6 | 31,5 |
| | 500 | 18,7 | 20,1 | 27,5 | 28,2 |
| | 630 | 18,0 | 19,0 | 24,9 | 25,5 |
| | 800 | 17,4 | 18,2 | 22,8 | 23,3 |
| M 900 | 250 | 34,8 | 39,6 | 62,8 | 65,7 |
| | 315 | 32,2 | 35,4 | 54,3 | 56,5 |
| | 400 | 30,3 | 32,7 | 47,8 | 49,5 |
| | 500 | 28,4 | 30,4 | 42,4 | 43,8 |
| | 630 | 27,1 | 28,7 | 38,3 | 39,3 |
| | 800 | 26,0 | 27,2 | 34,7 | 35,6 |
| M 1250 | 1000 | 25,2 | 26,2 | 32,2 | 32,9 |
| | 250 | 51,2 | 58,0 | 100,0 | 106,0 |
| | 315 | 47,0 | 52,3 | 85,7 | 90,2 |
| | 400 | 43,5 | 47,7 | 74,0 | 77,4 |
| | 500 | 40,8 | 44,2 | 65,3 | 68,1 |
| | 630 | 38,8 | 41,4 | 58,1 | 60,4 |
| M 1600 | 800 | 36,9 | 39,0 | 52,2 | 51,7 |
| | 1000 | 35,5 | 37,2 | 47,7 | 49,1 |



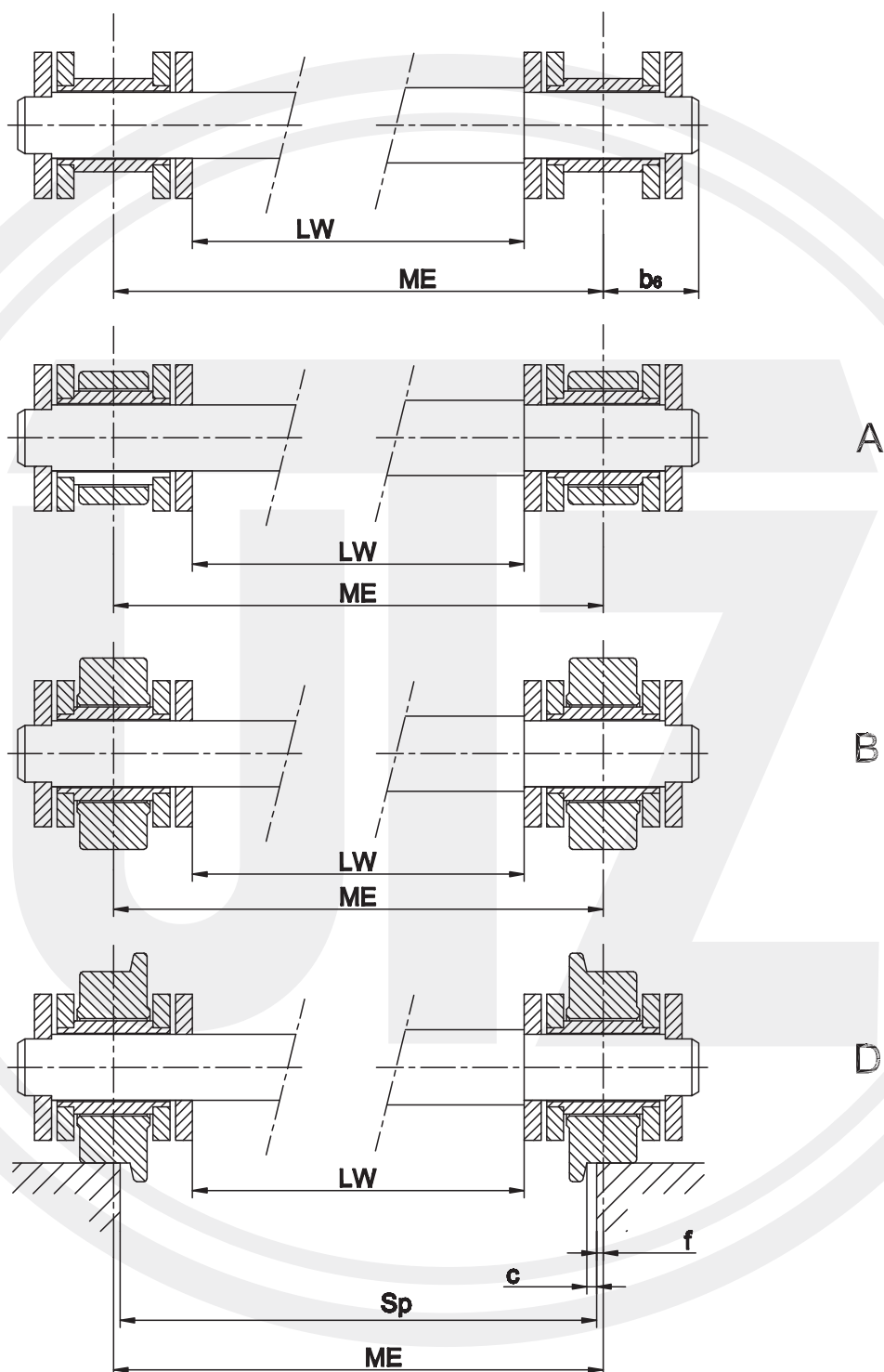

Mjere na upit



UTENZILIJA

Proizvodnja lanaca i transportera d.d.

POSEBNE IZVEDBE PRIJENOSNIH LANACA

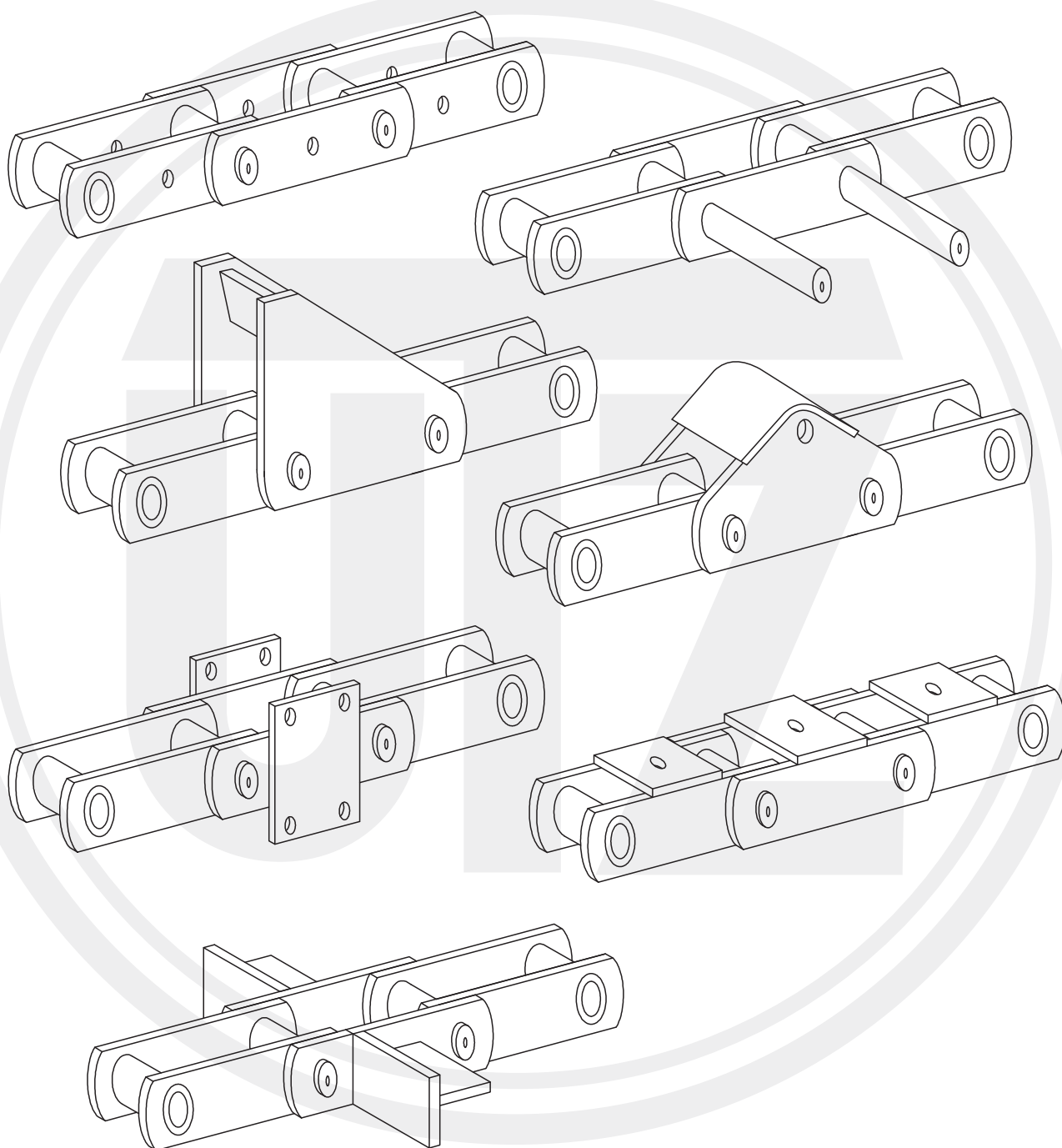

Mjere na upit.

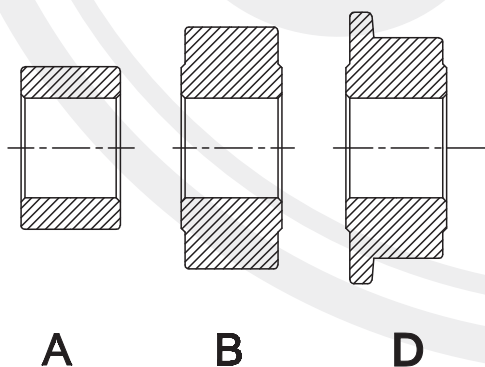
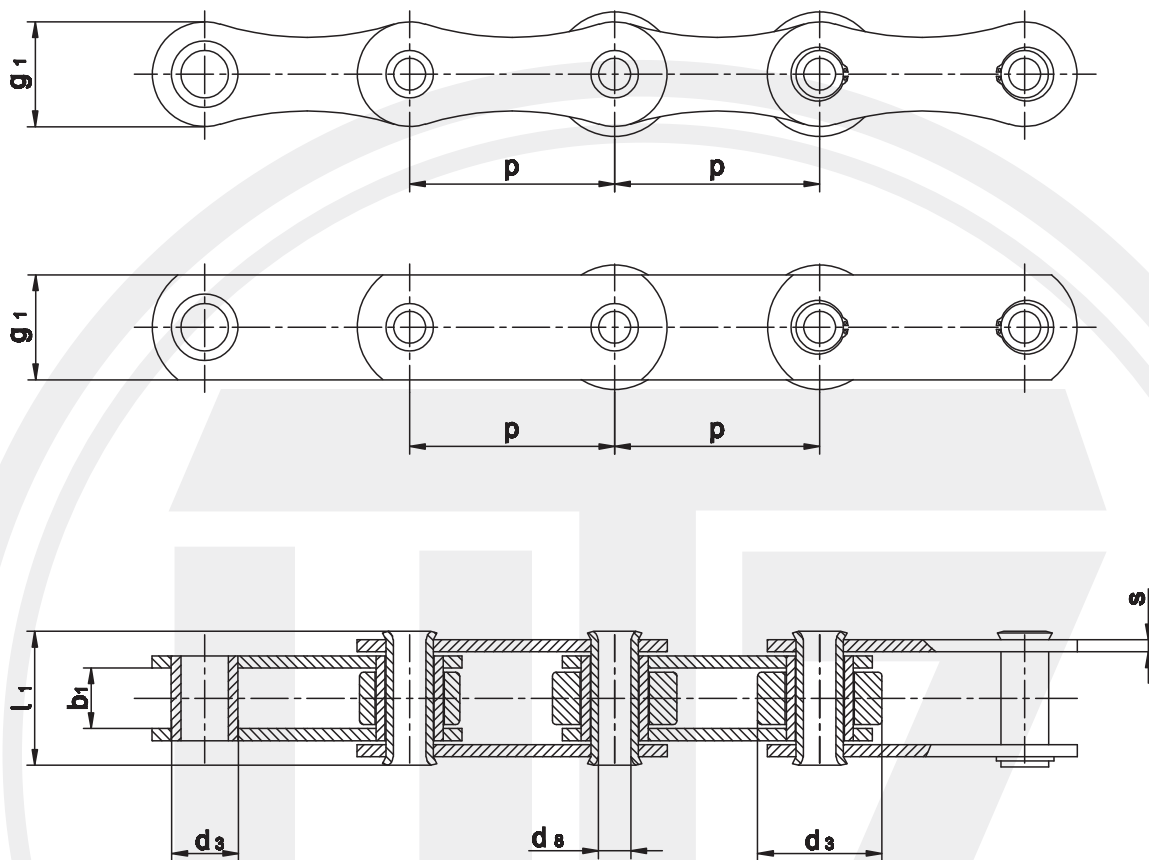

PRIMJERI OZNAČAVANJA LANACA SA ŠUPLJIM SVORNJACIMA PO TVORNIČKOJ NORMI:

1. 1 MC 20 - 30 x 14 x 12 - jednoredni tuljčasti lanac, prekidne sile lanca 20000 N, koraka 30 mm
2. A 1 MC 40 - 50 x 15 x 32 - jednoredni lanac sa valjkom tipa A, prekidne sile lanca 40000 N, koraka 50 mm
3. B 1 MC 40 - 50,8 x 15 x 32 - jednoredni lanac sa koturom tipa B, prekidne sile lanca 80000 N, koraka 50,8 mm
4. D 1 MC 20 - 50 x 15 x 31 - jednoredni lanac sa koturom tipa , prekidne sile lanca 20000 N, koraka 50 mm





| p | b ₁ | d ₃ | d ₈ | g ₁ | s ₁ /s ₂ | l ₁ | Fb | q |
|-------------|----------------|----------------|----------------|----------------|--------------------------------|----------------|---------|-------|
| mm | mm | mm | mm | mm | mm | mm | N | kg/m |
| * 19,05 | 11,68 | 12,07 | 5,8 | 16,1 | 1,8 | 22 | 14000 | 14000 |
| * 25,4 | 17,02 | 15,88 | 5,8 | 21 | 3/4 | 35 | 20000 | 2,52 |
| 30 | 14 | 12 (20) | 5,8 (6,1) | 20 | 3 (2,5) | 30 (28) | 20000 | |
| 35 | 14 | 12 (20) | | | | | | |
| * 50 | 15 | 31 | 5,8 | 21 | 3 | 31 | 20000 | 2,8 |
| * 50,8 | 10 | 30 | 8,2 | 26 | 3 | 27 | 30000 | 2,37 |
| 50,8 | 11,68 | 35 | 10,2 | 30 | 6 | 42 | 40000 | 4,5 |
| 38,1 | 15 | 25,4 | 10,2 | 26 (30) | 4 | 36 | 40000 | 3,96 |
| 41,4 | | | | | | | | 3,8 |
| 50 | 15 | 32 | 10,2 | 26 | 4 | 36 | 40000 | 4,1 |
| 50,8 | | | | | | | 40000 | 4,0 |
| 60 | | | | | | | | 3,6 |
| 63,5 | | | | | | | | 3,5 |
| 76,2 | | | | | | | | 3,2 |
| 85 | | | | | | | | 3,1 |
| 88,9 | | | | | | | | 3,0 |
| 100 | | | | | | | | 2,86 |
| 101,6 | | | | | | | | 2,83 |
| * 50,8 | 20 | 32 | 12,2 | 40 | 4/5 | 45 | 80000 | 6,1 |
| 76,2 | 19 | 47,6 | 13,9 | 40 | 4/5 | 43 | 80000 | 7,3 |
| 101,6 | | | | | | | | 6,2 |
| 152,4 | | | | | | | | 5,04 |
| 101,6 | 25 | 66,7 | 20,1 | 50 | 5/7 | 57 | 1120000 | 12,7 |
| 152,4 | | | | | | | | 9,8 |
| 203,2 | | | | | | | | 8,7 |
| 100 | 26 | 32 | 14,7 | 45 | 4 | 47 | 84000 | 5,1 |
| PATERNOSTER | | | | | | | | |

*=spojnice u obliku osmice

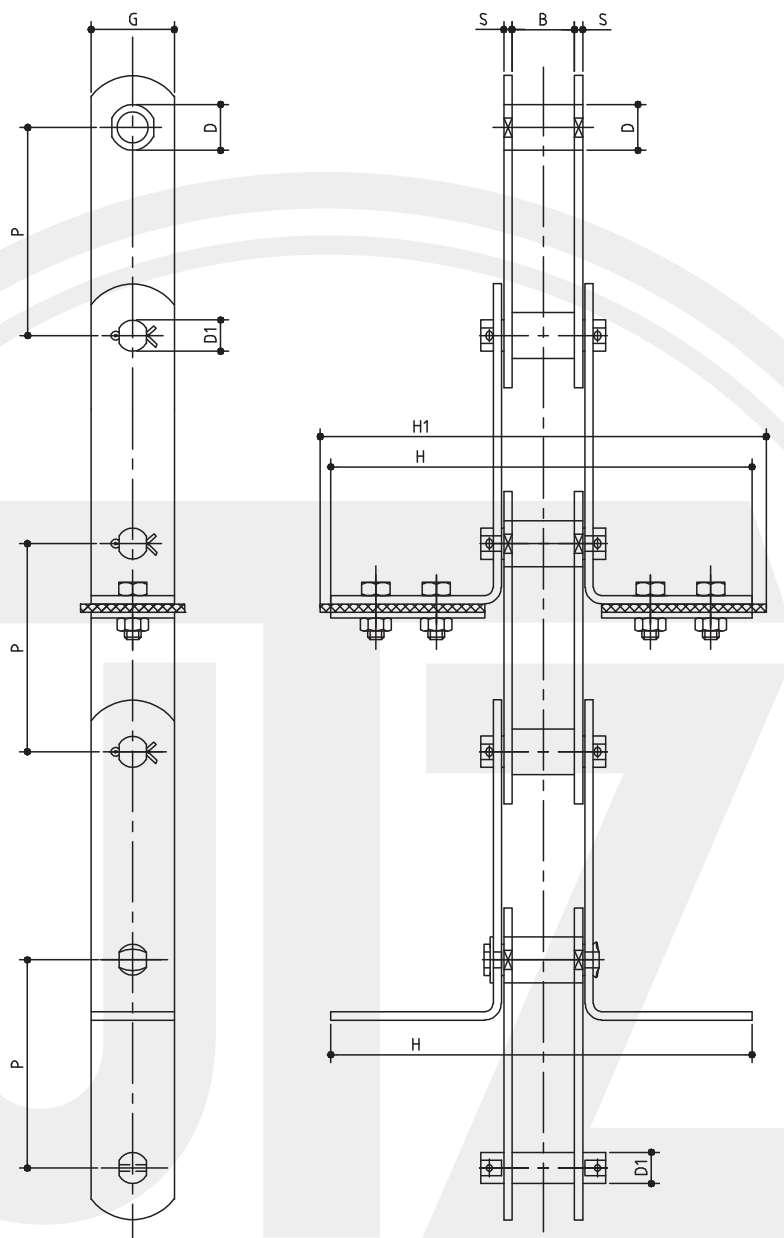

| Lanac GRABULJARA / REDLERA | Kapacitet Q (t/h) | Korak P (mm) | Promjer Tuljka D (mm) | Promjer Svornjaka D (mm) | Transportna Širina H ₁ (mm) | Svjetla Širina Članka B (mm) | Debljina i Visina Članka S i G (mm) |
|---|----------------------|-----------------|--------------------------|-----------------------------|---|---------------------------------|--|
| <p>Koriste se za kontinuirani transport žitarica, uljarica ili brašnastih komponenti u horizontalnim lančanim transporterima. Transport se može vršiti i pod nagibom, koji ovisi o vrsti transportnog medija.</p> <p>Izrađuju se od kvalitetnih čelika I to: Spojnice : konstrukcijski čelik Svornjaci: čelik za cementiranje Tuljci: čelik za cementiranje</p> <p>Po dužini transportnog dijela lanca, po zahtjevu se ugrađuju čistači, što osigurava bešuman rad lanaca i dobro čišćenje korita.</p> <p>Osiguranje svornjaka se vrši pomoću rascijepke, prema želji kupca svornjak se može zakovati ili osigurati uskočnikom.</p> | 150 | 150 | 30 | 18 | 325 | 35 / 45 | 8 50 |
| | 120 | 150 | 26 | 18 | 295 | 35 / 45 | 6 45 |
| | | 160 | | | | | 6 50 |
| | 90 | 150 | 26 | 18 | 260 | 35 | 6 45 |
| | | 160 | | | | | |
| | 60 | 150 | 22 | 16 | 210 | 30 / 35 | 6 40 |
| | | 160 | 25 | | | | 6 45 |
| | 30 | 140 | 22 | 16 | 160 | 25 / 30 | 5 35 |
| | | 150 | 25 | | | | 5 40 |
| | 15 | 120 | 22 | 16 | 115 | 20 / 30 | 5 35 |
| | | 140 | 25 | | | | 5 40 |



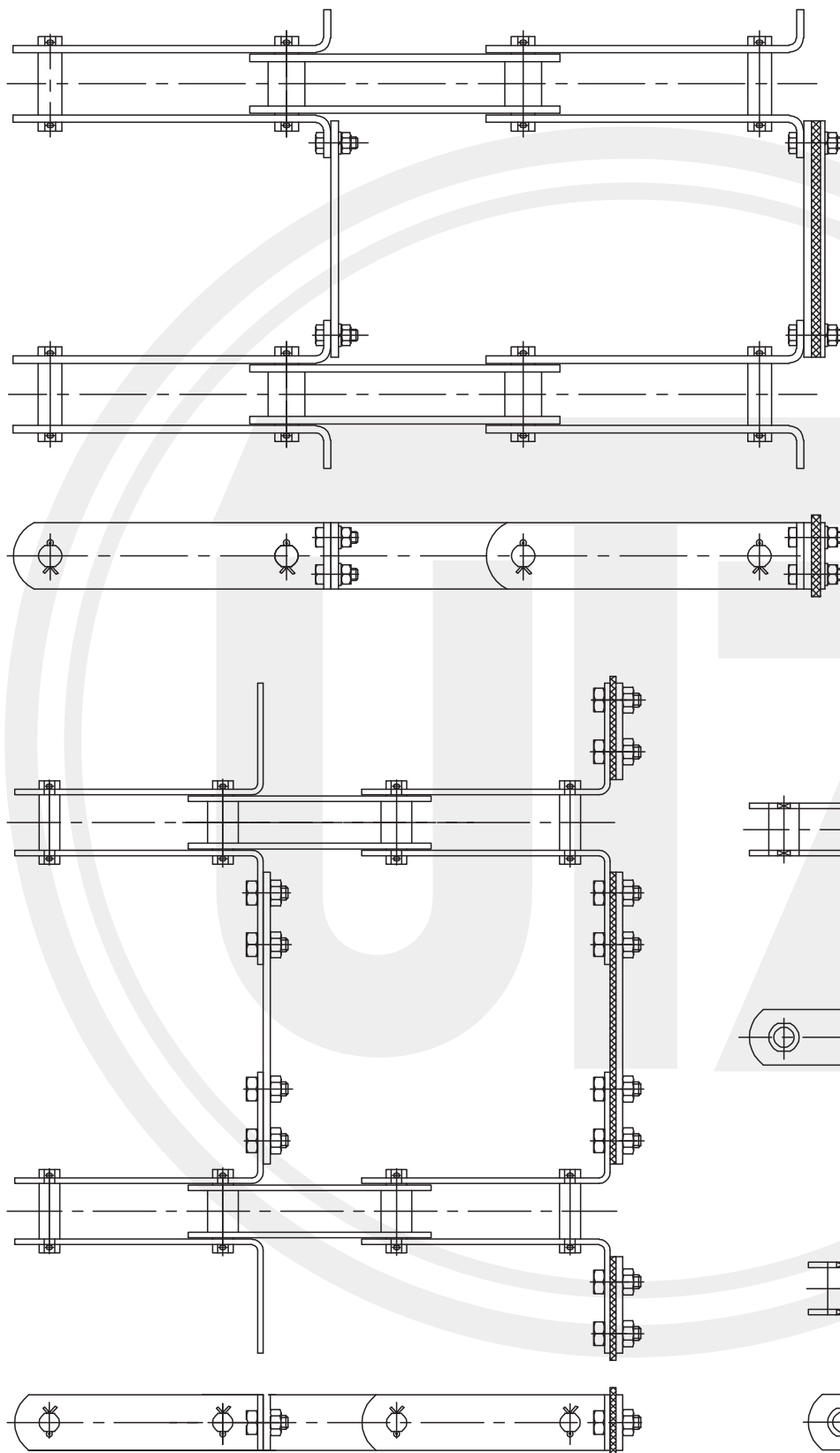

PRIMJERI ZA NARUDŽBU:

1. Za tipove grabuljara AT-2, BT-2, T-2, AL-2:
 $p \times b_1 \times d_2$ - tp grabuljara: $H \times G \times S$

2. Za tip grabuljara AL-611 - 2/0:
 $p \times b_1 \times d_2/a$ - AL-611- 2/0: $H_1 / H \times G \times S$

**Napomena: na lance se mogu ugraditi i čistači
(koža, plastika, itd.)**

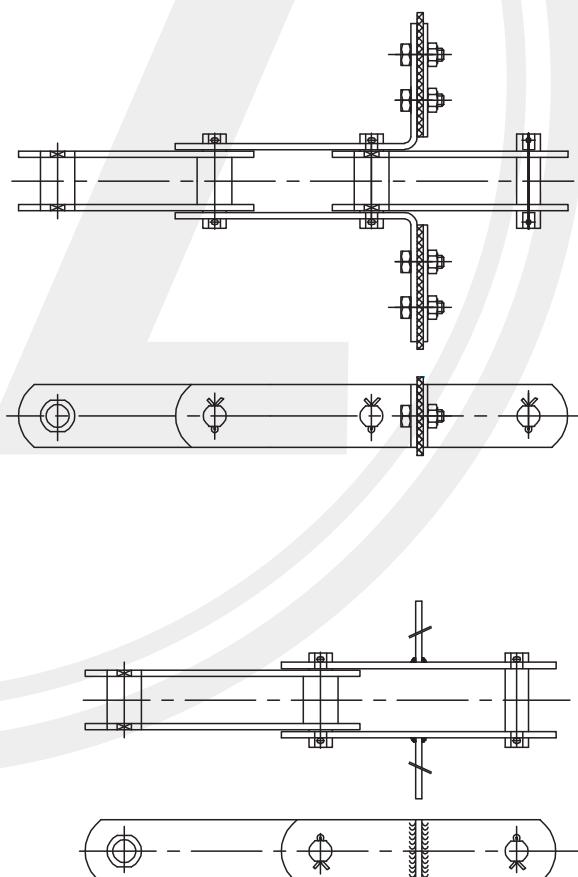

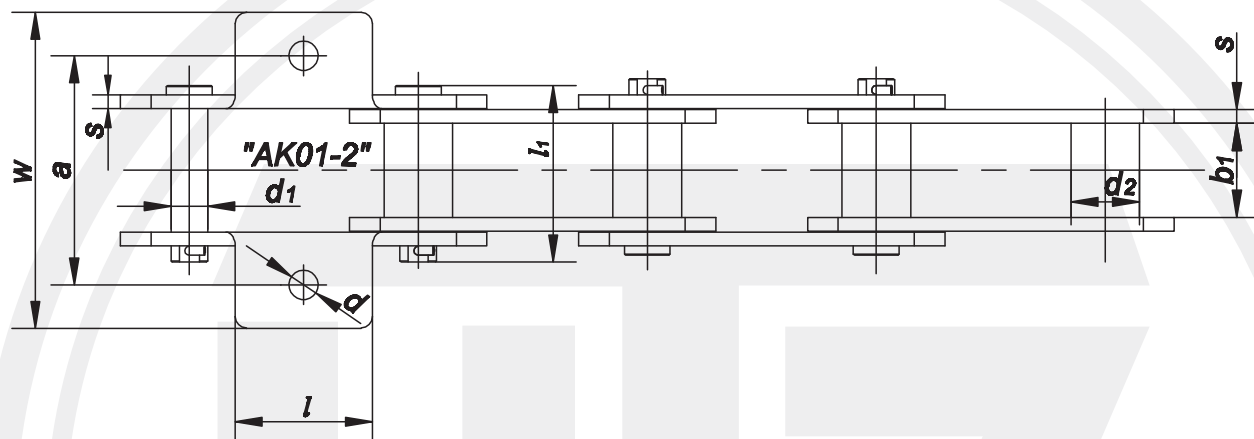
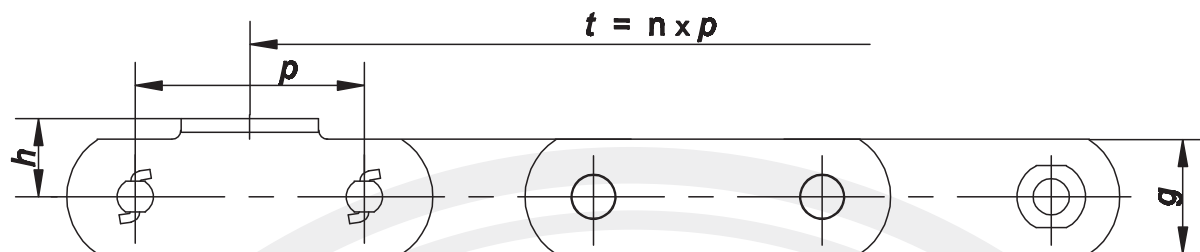

| mjere | p | b ₁ | d ₂ | d ₁ | g | s | l _{1 max} | d | a | h | l | w | z _z | F min |
|-----------|------|----------------|----------------|----------------|----|----|--------------------|----|-----|------|----|-----|----------------|---------|
| Lanac br. | mm | mm | mm | mm | mm | mm | mm | mm | mm | mm | mm | mm | mm | N |
| 65 DV | 65,5 | 33 | 25 | 15(16) | 40 | 6 | 68 | 13 | 90 | 29 | 32 | 120 | 0,4 | 115 000 |
| 65 BV | 65,5 | 50 | 28 | 20 | 45 | 6 | 69 | 13 | 116 | 31,5 | 48 | 160 | 0,4 | 135 000 |
| 100 DV | 100 | 29 | 27 | 16 | 45 | 6 | 73 | 13 | 100 | 31,5 | 58 | 138 | 0,5 | 150 000 |
| 100BV | 100 | 41 | 30 | 16 | 50 | 6 | 80 | 13 | 100 | 34 | 60 | 140 | 0,5 | 150 000 |
| 125 DV | 125 | 41 | 30 | 16 | 50 | 6 | 80 | 17 | 100 | 34 | 60 | 140 | 0,5 | 150 000 |
| 150 DV | 150 | 45 | 40 | 26 | 65 | 9 | 102 | 17 | 145 | 45 | 80 | 205 | 0,8 | 300 000 |

Napomena : - zračnost u zglobu povećana (z_z)

- parovi svornjaka naizmjenično ugrađeni

- udaljenost između nosivih spojnica (članaka) izraziti u mm
ili kao " n " -ti članak (t)

Primjer za narudbu:

Lanac br. - nosivi članak na " t " mm ili na n x p mm
100 DV - nosivi članak na 400 mm ili na 4 x 100 mm - AK01-2.2

Količina : u metrima ili broju članaka

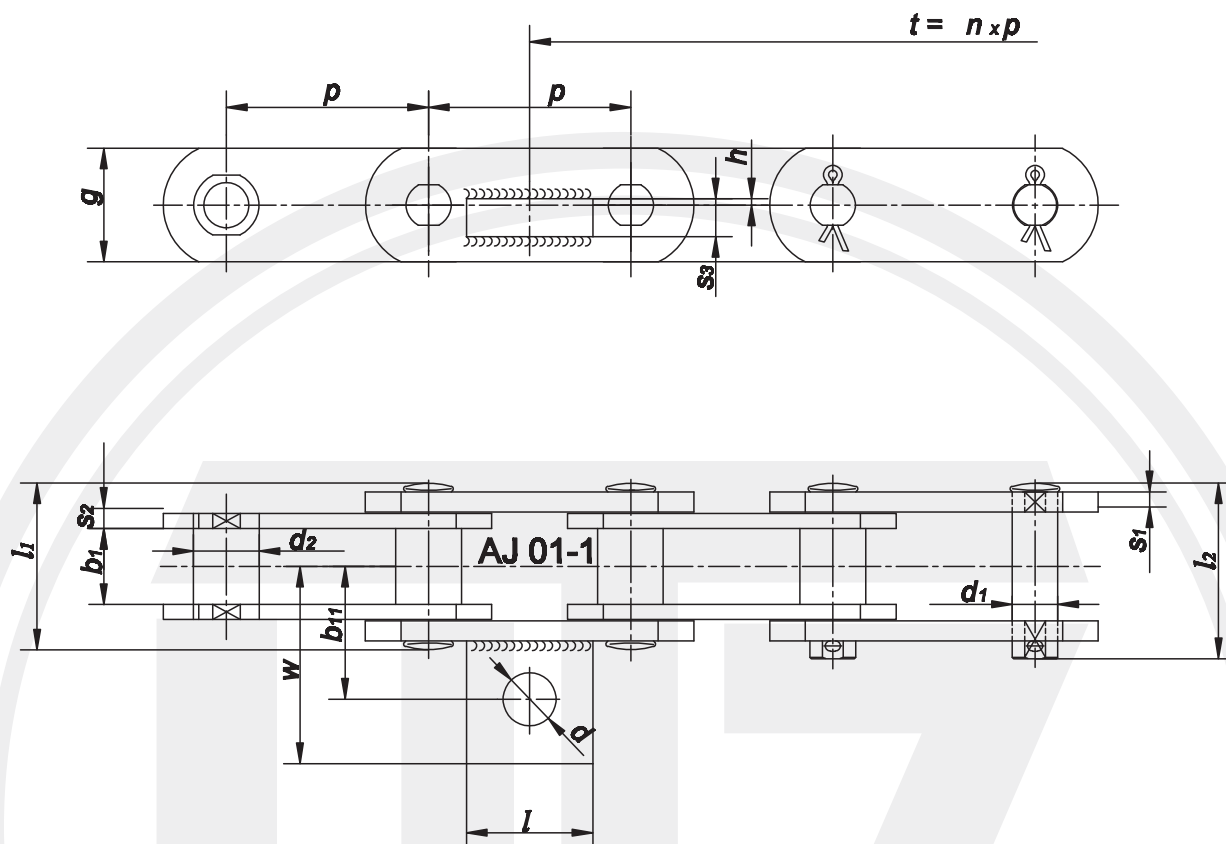

| p | b_1 | d_2/d_3 | d_1 | g | s_1/s_2 | l_1/l_2 | s_3 | l | d | b_{11} | h | w | F_b | q |
|-----|-------|-----------|-------|-----|-----------|-----------|-------|-----|-----|----------|-----|-----|---------|------|
| mm | mm | mm | mm | mm | mm | mm | mm | mm | mm | mm | mm | mm | N | kg/m |
| 50 | 35 | 26 | 18 | 45 | 6;15/8 | 72;97/78 | 15 | - | - | - | - | - | 200 000 | 12,6 |
| 70 | 32 | 21(22) | 16 | 40 | 6;10/6 | 64;68/68 | 20 | 40 | 20 | 57,5 | 0 | 78 | 200 000 | 8,3 |
| 80 | 35 | 26 | 18 | 45 | 8/6 | 73/76 | 15 | 50 | 21 | 57,5 | 2,5 | 83 | 200 000 | 10 |
| 80 | 34 | 27,94 | 15,9 | 45 | 8/6 | 72/75 | 15 | 50 | 21 | 55 | 2,5 | 78 | 200 000 | 10 |

~~d₃ - promjer valjka~~

Primjer za narudbu:

- Lanac - $p \times b_1 \times d_2(d_3)$ - nosivi članak na "t" mm ili na $n \times p$ mm
- 1 FV 200 - 80 x 35 x 26 - nosivi članak na 640 mm ili na 8 x 80 mm ; AJ 01-1.4

Količina : u metrima ili broju članaka

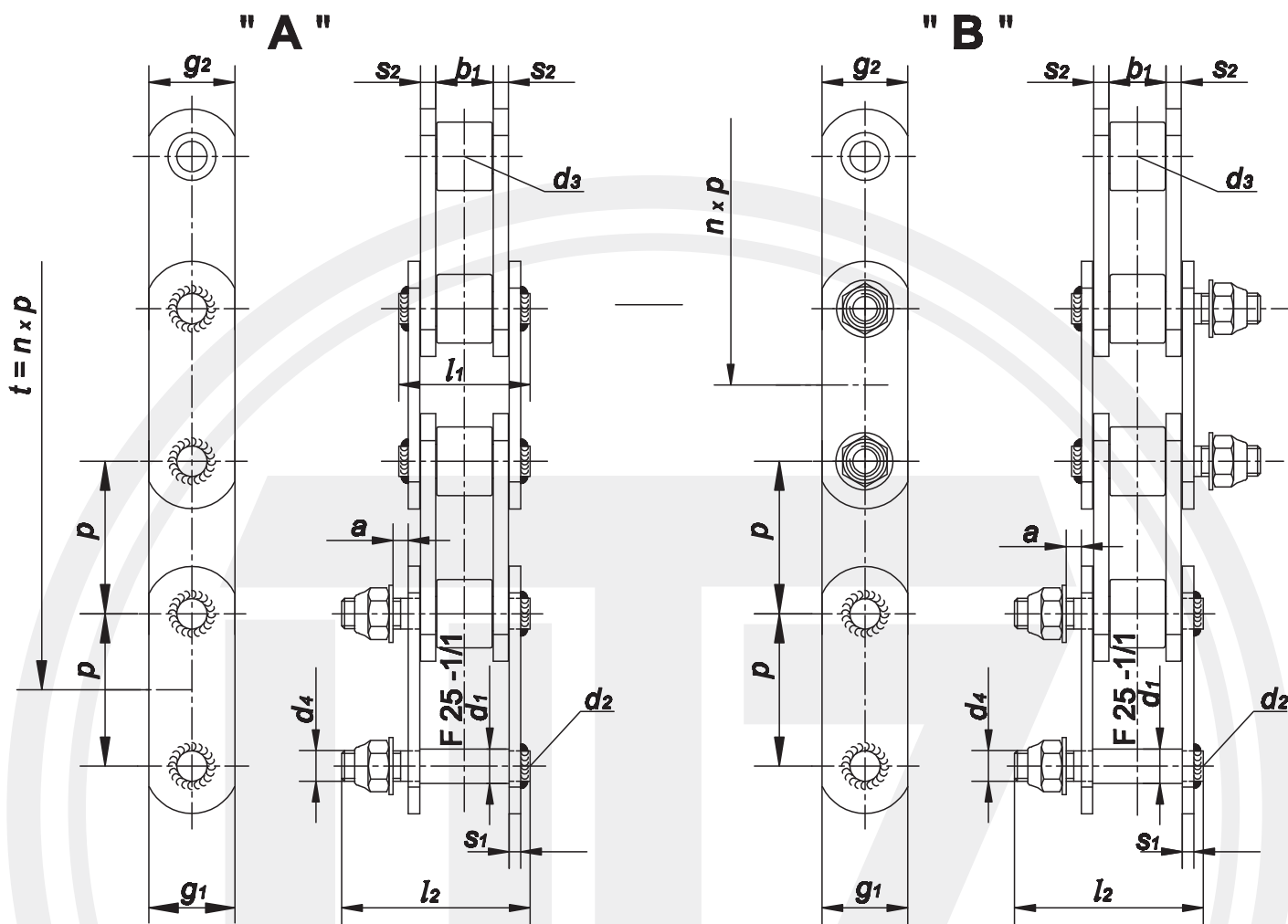

| mjere | p | b ₁ | d ₃ | d ₁ | g ₁ /g ₂ | s ₁ /s ₂ | l ₁ / l ₂ | a | d ₂ | d ₄ | F _b | q |
|-------|-----|----------------|----------------|----------------|--------------------------------|--------------------------------|---------------------------------|----|----------------|----------------|----------------|-------|
| Tip | mm | mm | mm | mm | mm | mm | mm | mm | mm | mm | N | kg/m |
| A | 50 | 25,4 | 25,4 | 14,63 | 40 | 5/6 | 64/83 | 7 | 12,3 | M 12 | 160 000 | 9,20 |
| A i B | 80 | 30 | 36 | 18 | 45 | 8/6 | 76/100 | 7 | 16,1 | M 16 | 200 000 | 13,10 |
| A | 80 | 35 | 42 | 20 | 50 | 8/8 | 85/110 | 8 | 18,1 | M 16 | 300 000 | 16,30 |
| A | 85 | 35 | 45 | 20 | 50 | 8/8 | 85/110 | 8 | 18 | M 16 | 300 000 | 16,40 |
| B | 100 | 45 | 60 | 25 | 60/70 | 10/10 | 141 | 10 | 23 | M 22 | 700 000 | 30,00 |

Primjer za narudbu:

- Lanac tip - $p \times b_1 \times d_3$ nosivi članak na " t " mm ili na " $n \times p$ " mm
- A - 80 x 30 x 36 F 25-1/1.2 na 320 mm ili na 4 x 80 mm
- B - 80 x 30 x 36 F 25-1/1 na 160 mm ili na 2 x 80 mm

Količina : - u metrima ili broju članaka

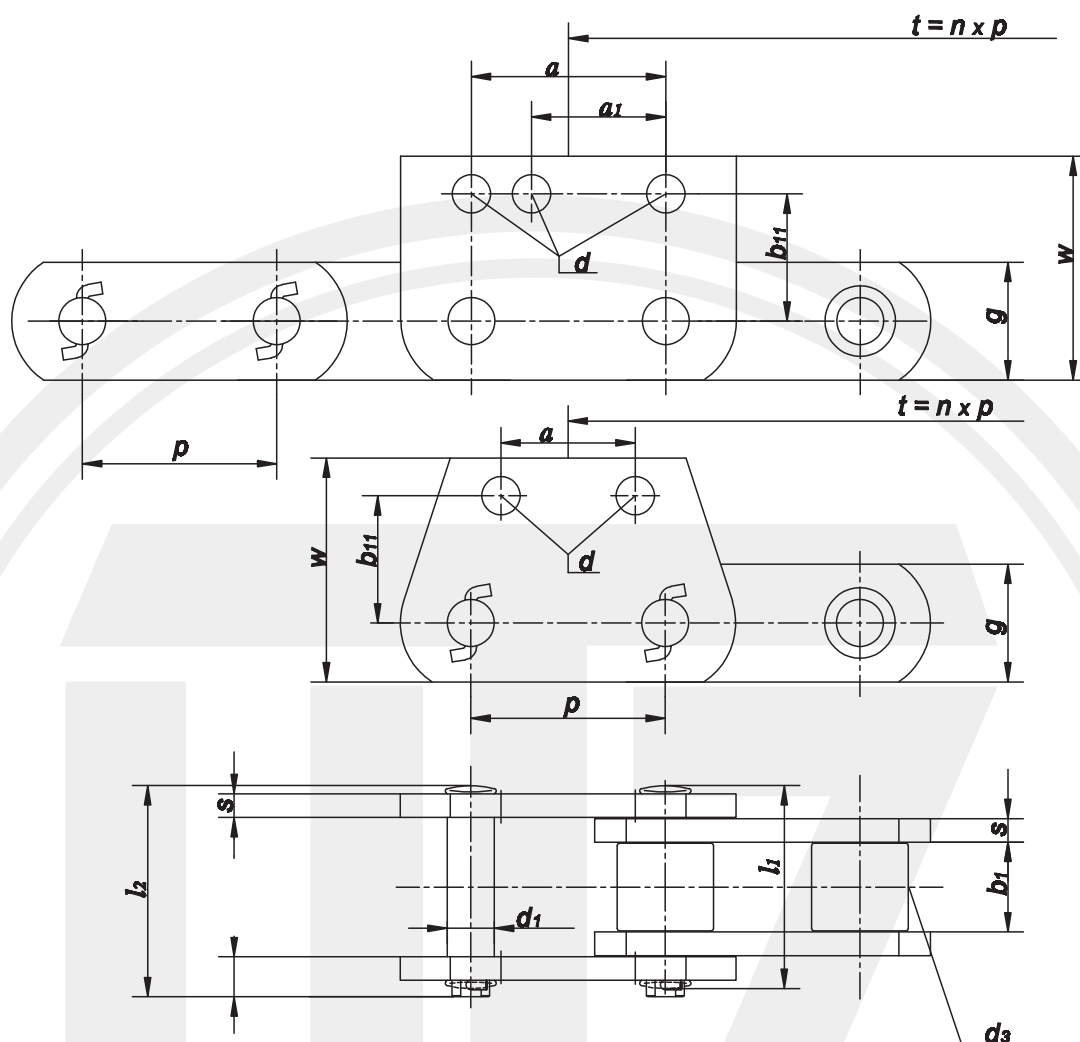

| p mm | b_1 mm | d_3 mm | d_1 mm | g mm | s mm | l_1/l_2 mm | d mm | $a(a_1)$ mm | b_{11} mm | w mm | F_b N | q kg/m |
|-----------|-------------|-------------|-------------|-----------|-----------|-----------------|-----------|----------------|----------------|-----------|------------|-------------|
| 42,01 | 25,4 | 22,23 | 11,7 | 30 | 5 | 52/55 | 10,5 | (25,4) | 28,5 | 54 | 90 000 | 6,7 |
| 42,01 | 25,4 | 22,23 | 11,7 | 30 | 6 | 56/59 | 10,5 | 41,4(25,4) | 34 | 60 | 140 000 | 7,8/8,9 |
| 50,8 | 31,75 | 28,58 | 14,63 | 40 | 6 | 64/68 | 14,5 | 50,8 | 38,1 | 75 | 200 000 | 11,9/12,7 |
| 66,27 | 31,75 | 28,58 | 14,63 | 40 | 6 | 64/68 | 16,5 | 50,8 | 41,4 | 78 | 200 000 | 10,7 |
| 67,15 | 31,8 | 31,8 | 16 | 45 | 8 | 74/77 | 16,5 | 57 | 50,8 | 90 | 250 000 | 18,4 |
| 69,85 | 31,8 | 31,8 | 16 | 45 | 8 | 74/77 | 16,5 | 57 | 50,8 | 90 | 250 000 | 17,5 |
| 77,9 | 31,8 | 31,8 | 16 | 45 | 8 | 80/84 | 16,5 | 57 | 50,8 | 90 | 250 000 | 16 |
| 77,9 | 38,1 | 41,3 | 20 | 50 | 8 | 80/84 | 21 | 77,9 | 50,8 | 95 | 300 000 | 20,7 |
| 82,5 | 38,1 | 41,3 | 20 | 50 | 10 | 90/94 | 16,5 | 57 | 54 | 95 | 360 000 | 22,8 |
| 114,3 | 48,4 | 57,2 | 22 | 70 | 12 | 111/115 | 21 | 114,3 | 66,5 | 122,5 | 500 000 | 37 |

Primjer za narudbu:

-Lanac - $p \times b_1 \times d_3$ - nosivi članak na "t" mm ili na $n \times p$ mm

-A1 FV 300 - 77,9 x 38,1 x 41,3 - nosivi članak na 155,8 mm ili 2 x 77,9 mm AMO 2-2

Količina : - u metrima ili broju članaka

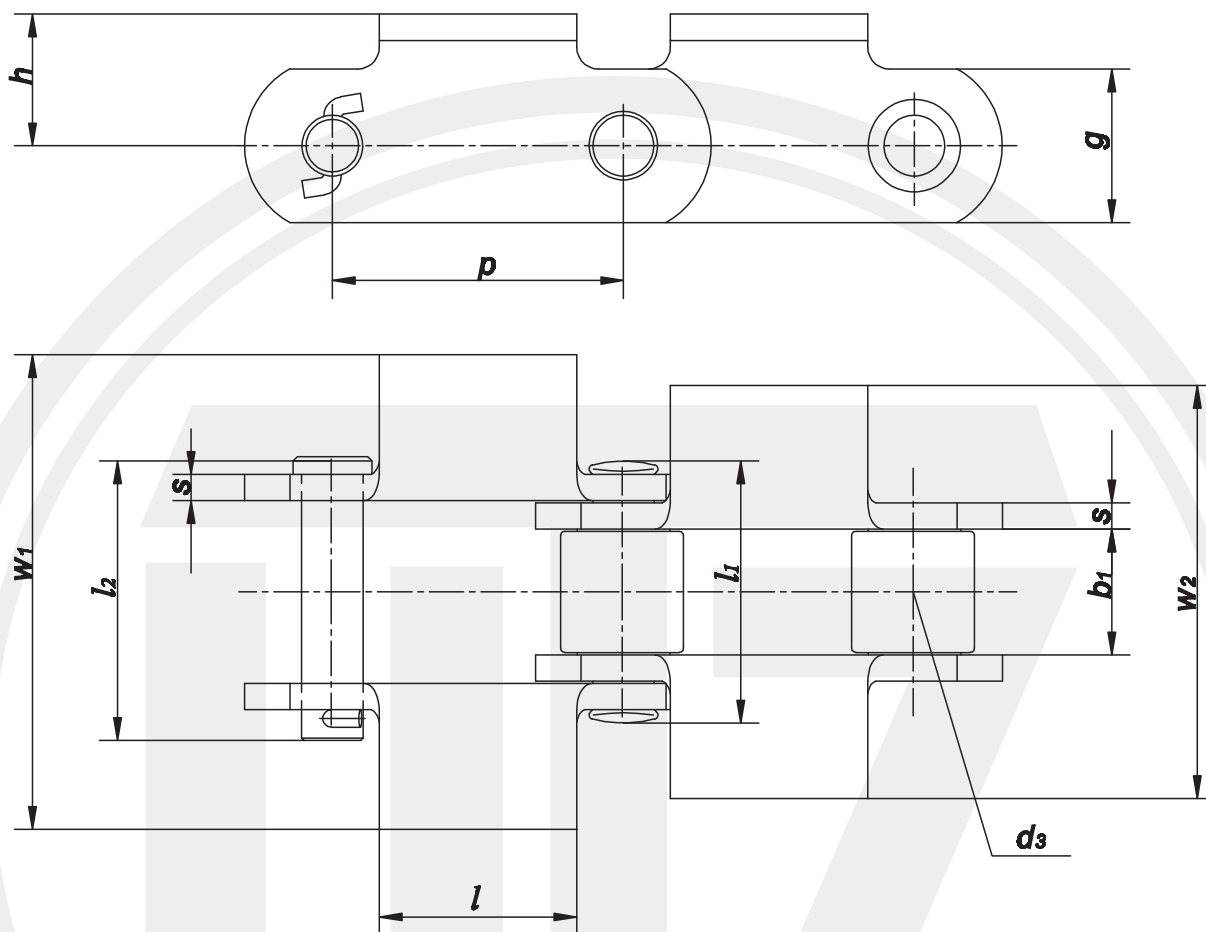

| p | b_1 | d_3 | d_1 | g | s | l_1/l_2 | w_1 | w_2 | l | h | F_b | q |
|-------|-------|-------|-------|-----|-----|-----------|-------|-------|-----|------|---------|------|
| mm | mm | mm | mm | mm | mm | mm | mm | mm | mm | mm | N | kg/m |
| 66,27 | 21 | 22,23 | 11,70 | 35 | 6 | 52/55 | 108 | 94 | 45 | 30 | 112 000 | 8,7 |
| 66,27 | 28,58 | 28,58 | 14,63 | 45 | 8 | 68/72 | 152 | 135 | 48 | 31,5 | 160 000 | 15,8 |

Primjer za narudbu:

- Lanac $p \times b_1 \times d_3$ - nosivi članak K-2

Količina : - u metrima ili broju članaka

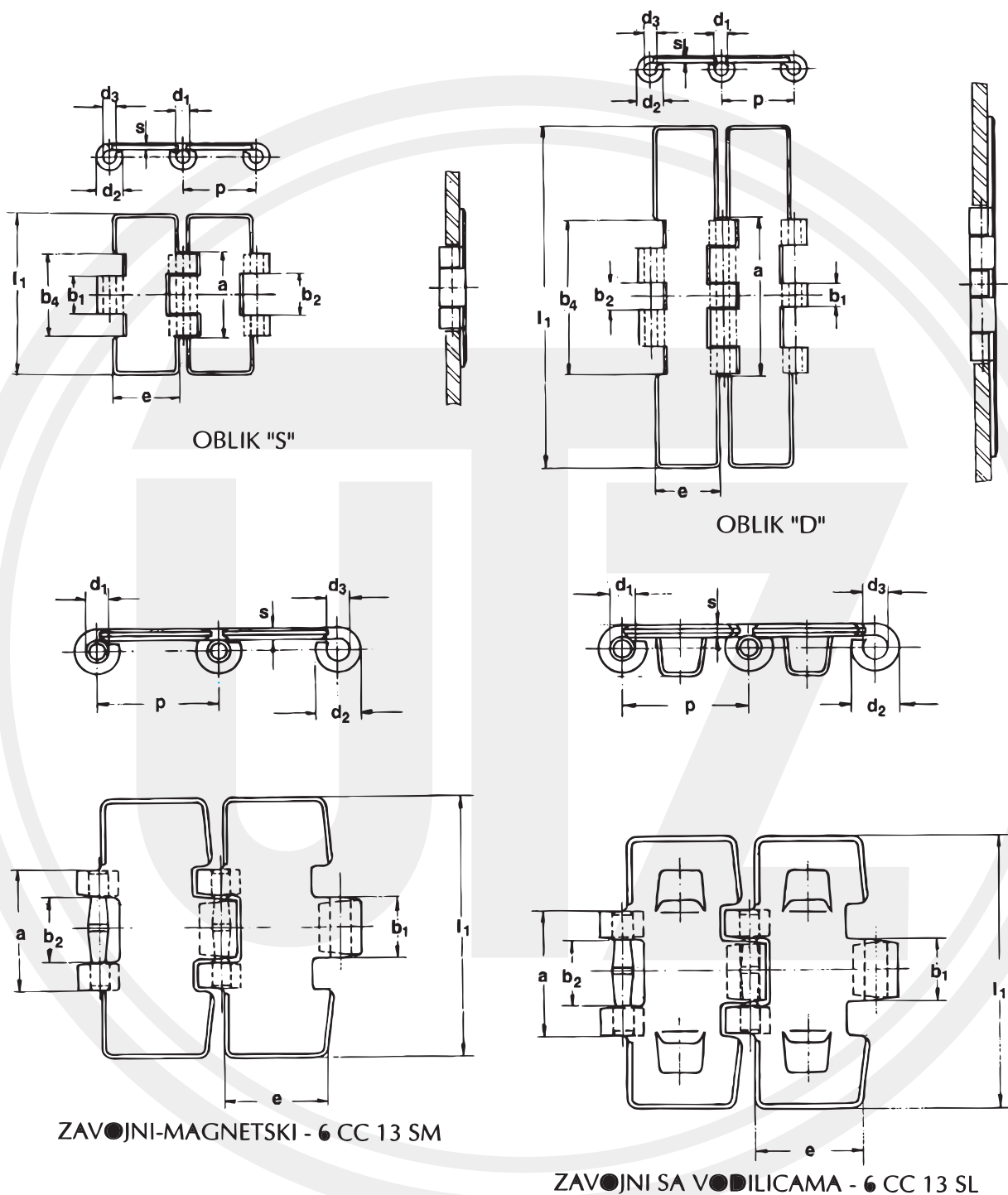

PRIMJERI ZA NARUDŽBU:

1. Narudžba šarnirnog lanca s oznakom 6C123S, koraka 38,1 mm:
ŠARNIRNA LANČANA TRAKA DIN 8153-6 C 13 S
2. Narudžba zavojnog šarnirnog lanca, koraka 38,1 mm, sa magnetskim vođenjem:
ZAVOJNA ŠARNIRNA LANČANA TRAKA DIN 8153-6 C 13 S M



| OZNAKA LANCA | p | a | b ₁ | b ₂ | d ₁ | d ₂ | d ₃ | e | s | l ₁ | Fb | q |
|-----------------|------|------------|----------------|----------------|----------------|----------------|----------------|------------|------------|----------------|-------|------|
| | mm | mm max. | mm max. | mm max. | mm max. | mm max. | mm max. | mm max. | mm max. | mm | N | kg/m |
| 4 C 8,5 S | | | | | | | | | | 54 | | 2,42 |
| 4 C 9,6 S | | | | | | | | | | 61,5 | | 2,56 |
| 4 C 11,2 S | 25,4 | 42,6 | 20 | 20,1 | 6,38 | 13,13 | 6,4 | 24,58 | 3,35 | 71,3 | 8000 | 2,81 |
| 4 C 13 S | | | | | | | | | | 82,5 | | 3,09 |
| 4 C 16 S | | | | | | | | | | 101,6 | | 3,25 |
| 6 C 12 S | | | | | | | | | | 76,2 | | 2,4 |
| 6 C 13 S | | | | | | | | | | 82,5 | | 2,6 |
| 6 C 14 S | | | | | | 13,13 | | | | 88,9 | | 3 |
| 6 C 16 S | 38,1 | 42,6 | 20 | 20,1 | 6,38 | 13,13 | 6,4 | 37,28 | 3,35 | 101,6 | 9500 | 3,3 |
| 6 C 24 S | | | | | | | | | | 152,4 | | 4,2 |
| 6 C 30 S | | | | | | | | | | 190,5 | | 5 |
| 6 C 30 D | 38,1 | 81 | 13,5 | 13,7 | 6,38 | 13,13 | 6,4 | 37,28 | 3,35 | 190,5 | 14000 | 5,6 |
| 6 CC 13 SM | 38,1 | 37 | 19 | 20 | 6,38 | 12,7 | 6,4 | 33 | 3 | 82,5 | 7500 | 2,3 |
| 6 CC 13 SL | 38,1 | 37 | 19 | 20 | 6,38 | 12,7 | 6,4 | 33 | 3 | 82,5 | 7500 | 2,3 |

Objašnjenje znakova:

Primjer 1: 4 C 9,6 S = lanac koraka 25,4 mm, širine trake 61,5 mm, sa dvije uške, odnosno, oblika "S"

Primjer 2: 6 C 30 D = lanac koraka 38,1 mm, širine trake 190,5 mm, sa tri uške, odnosno, oblika "D"

Primjer 3: 6 CC 13 SL = zavojni šarnirni lanac koraka 38,1 mm, širine trake 82,5 mm, sa dvije uške, odnosno, oblika "S", vođenje sa vodicom

Materijal: Nehrđajući Čelik (W. Nr. 4021), Kaljen.

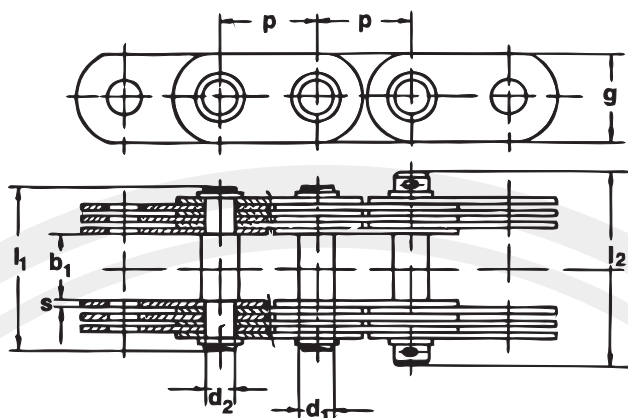

ZAVRŠNA SPOJNICA "A"

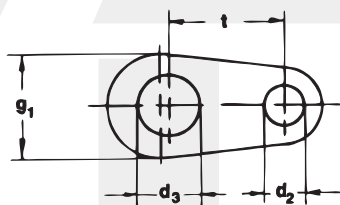

PRIMJER ZA NARUDŽBU:

1. Narudžba 10 m Gallovog lanca koraka 50 mm
10 m GALLOVOG LANCA DIN 8150-50
2. Narudžba 5 komada istog lanca sa 41 člankom:
5 komada GALLOVOG LANCA DIN 8150-50x41
3. Označavanje završne spojnice "A" za jedan Gallov lanac, koraka 90 mm:
ZAVRŠNA SPOJNICA DIN 8150-A 90

| p | t | b ₁ | d ₁ | d ₂ | d ₃ | g | g ₁ | s | l ₁ | l ₂ | n | F _b | q |
|------|-----|----------------|----------------|----------------|----------------|-----|----------------|-----|----------------|----------------|---|----------------|------|
| mm | mm | mm | mm | mm | mm | mm | mm | mm | mm | mm | | N | kg/m |
| 15 | 20 | 12 | 5 | 4 | 9 | 12 | 18 | 2 | 25 | 27 | 2 | 5000 | 0,7 |
| 20 | 25 | 15 | 8 | 6 | 10 | 15 | 20 | 2 | 28 | 23 | 2 | | 1,1 |
| 25 | 30 | 18 | 10 | 8 | 12 | 18 | 25 | 3 | 36 | 42 | 2 | 12500 | 1,8 |
| 30 | 40 | 20 | 11 | 9 | 14 | 20 | 30 | 3 | 51 | 58 | 4 | 40000 | 3,4 |
| 35 | 45 | 22 | 12 | 10 | 16 | 26 | 35 | 3 | 53 | 61 | 4 | 60000 | 4,5 |
| 40 | 50 | 25 | 14 | 12 | 18 | 32 | 40 | 3 | 58 | 66 | 4 | 80000 | 5 |
| 45 | 55 | 30 | 17 | 14 | 22 | 35 | 45 | 3 | 63 | 70 | 4 | 100000 | 7 |
| 50 | 60 | 35 | 22 | 18 | 26 | 40 | 50 | 4,5 | 90 | 97 | 4 | 150000 | 11,3 |
| 55 | 65 | 40 | 24 | 21 | 32 | 42 | 55 | 6 | 108 | 115 | 4 | 200000 | 14,5 |
| 60 | 70 | 45 | 26 | 23 | 36 | 46 | 60 | 6 | 114 | 120 | 4 | 250000 | 17,1 |
| *70 | 85 | 50 | 32 | 28 | 40 | 55 | 70 | 6 | 148 | 157 | 6 | 375000 | 34 |
| *80 | 100 | 60 | 36 | 32 | 50 | 60 | 85 | 6 | 159 | 171 | 6 | 500000 | 39 |
| *90 | 120 | 70 | 40 | 36 | 60 | 70 | 100 | 7 | 184 | 200 | 6 | 750000 | 53 |
| *100 | 140 | 80 | 45 | 40 | 70 | 80 | 120 | 7 | 224 | 234 | 8 | 1000000 | 77 |
| *110 | 160 | 90 | 50 | 45 | 80 | 90 | 140 | 7 | 236 | 251 | 8 | 1250000 | 90 |
| *120 | 180 | 100 | 55 | 50 | 90 | 100 | 160 | 8 | 262 | 277 | 8 | 1500000 | |

n - broj spojnice po članku

* - lanci sa ravnim spojnica

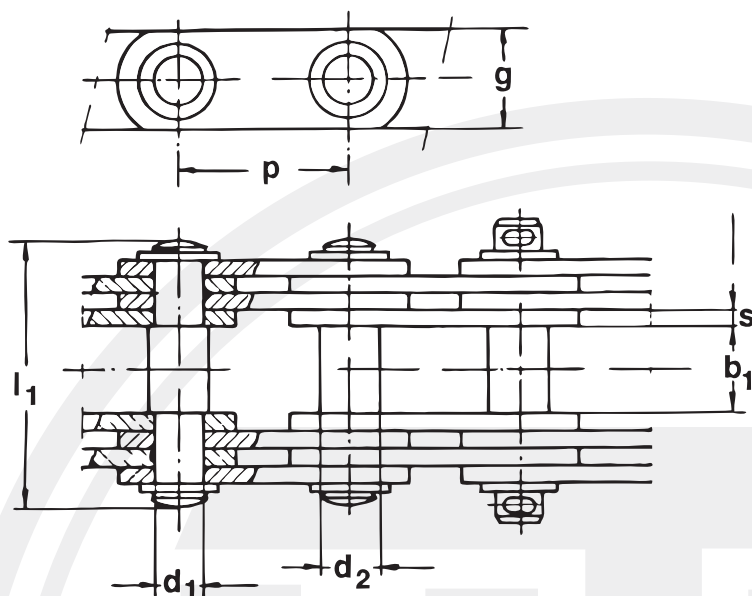

PRIMJER ZA NARUDŽBU:

1. Narudžba 10 m lanca za vučne klupe
DIN 8156-160
10 m LANCA ZA VUČNE KLUPE
DIN 8156-160
2. Narudžba 5 komada istog lanca
od 41 članka:
5 komada LANCA ZA VUČNE
KLUPE DIN 8156-160 x 41

| p | b ₁ | d ₂ | d ₁ | g | l ₁ | s | Fb | q |
|-----|----------------|----------------|----------------|-----|----------------|----|---------|------|
| mm | mm | mm | mm | mm | mm | mm | N | kg/m |
| 30 | 20 | 11 | 9 | 20 | 60 | 3 | 30000 | 4 |
| 50 | 25 | 14 | 12 | 30 | 71 | 3 | 60000 | 6 |
| 60 | 35 | 22 | 20 | 40 | 103 | 5 | 190000 | 14 |
| 70 | 45 | 28 | 25 | 50 | 143 | 8 | 380000 | 27 |
| 90 | 60 | 36 | 32 | 60 | 183 | 10 | 600000 | 42 |
| 110 | 70 | 45 | 40 | 80 | 211 | 12 | 960000 | 68 |
| 120 | 80 | 50 | 45 | 80 | 248 | 15 | 1200000 | 83 |
| 160 | 100 | 60 | 55 | 100 | 320 | 20 | 1900000 | 130 |
| 180 | 120 | 80 | 70 | 130 | 385 | 25 | 3000000 | 220 |
| 240 | 140 | 90 | 80 | 160 | 456 | 30 | 1800000 | 305 |
| 280 | 160 | 110 | 110 | 200 | 481 | 30 | 6000000 | 395 |

This image shows a full page of blank, lined paper. It features approximately 20 evenly spaced horizontal grey lines across its entire width, providing a guide for handwriting or typing. The paper itself is a clean, off-white color.

[illegible]